



# Selected Inventory of Historic Resources

Village of Sagaponack, Long Island, New York

February 2017, by Sally Spanburgh



Village of Sagaponack  
**Inventory of Selected Historic Structures Outside the National Register Historic District**  
 Sally Spanburgh – February 2017

**Introduction & List of Properties Inventoried**

This selected inventory of historic resources was compiled at the request of the Village of Sagaponack and consists of sixteen structures located outside the National Register Historic District and listed in a letter compiled by Ann Sandford dated September 25, 2012. The names of the properties in this inventory are the same as they were referred to in the Sanford letter (they have not been changed based on research) but will be found in a slightly different order than as listed in the 2012 letter. The purpose of this inventory is to aid in the Village's protection and preservation of these properties, and to equip the Village and public with a better understanding of their value and history beyond that which can be accomplished with a mere list and local oral history type anecdotes. Many resources were consulted in order to discover background information on the historic resources and their owners including but not limited to books, magazines, newspapers, the internet, genealogy databases, historic maps and atlases, library and historical society collections, etc.

#	Name	SCTM#	Address	Approx. Year Built
1	Topping-Reed House	908-1-4-9	52 Sagaponack Main Street	1730/1750
2	Topping-Neylon House	908-4-1-5	65 Sagaponack Main Street	1800
3	Mott-Topping House	908-2-2-19	35 Sagg Road	1740
4	Gabled House	908-2-2-9	109 Sagg Road	1800/1900/2000
5	Hildreth-Wolffer House	908-2-2-5	175 Sagg Road	1870
6	Talmadge Farmhouse	908-1-2-25	218 Sagg Road	1905
7	Osborne-Rutkowski House	908-4-3-37	444 Parsonage Lane	1895
8	Hedges House	908-6-3-41	243 Hedges Lane	1842
9	Deacon David Hedges House	908-6-3-25	414 Hedges Lane	1775
10	Hedges-Musnicki-Galban House	908-7-1-25	452 Hedges Lane	1830
11	Sylvanus Strong-Bennett House	908-7-2-26	700 Hedges Lane	1775
12	Presbyterian Parsonage	908-7-2-24	440 Town Line Road	1845
13	Stephen (Jared) Hedges House	908-4-3-40	602 Town Line Road	1730
14	Farmhouse	908-4-3-40	602 Town Line Road	1906
15	Strong Farmhouse	908-7-2-4	603 Town Line Road	1847
16	Strong Cottage	908-7-2-3	591 Parsonage Lane	1900

Village of Sagaponack  
 Inventory of Selected Historic Structures Outside the National Register Historic District  
 Sally Spanburgh – February 2017

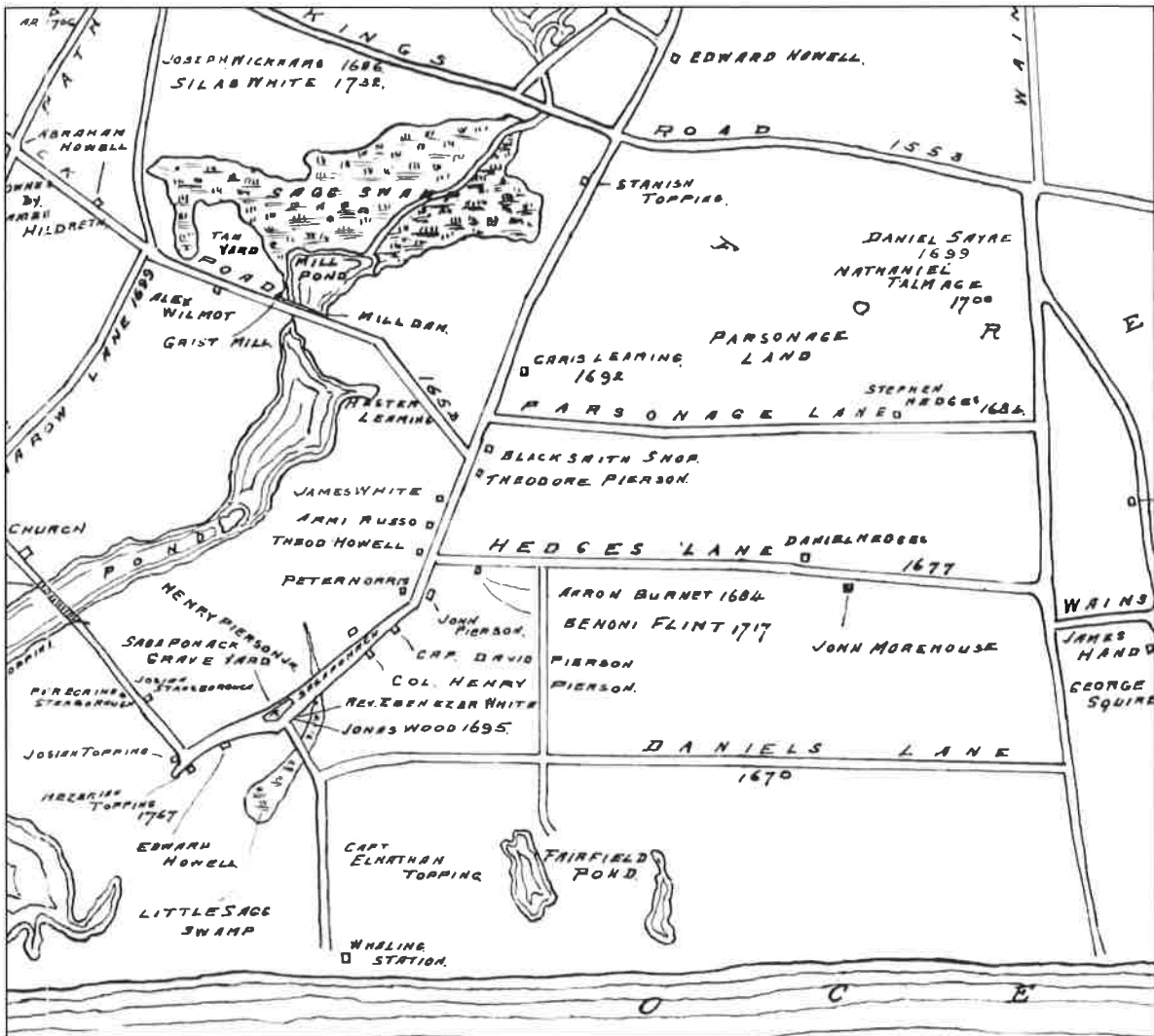

Detail, 1700 Map, from Sketches from Local History, by William Donaldson Halsey, 1935.



Village of Sagaponack  
 Inventory of Selected Historic Structures Outside the National Register Historic District  
 Sally Spanburgh – February 2017

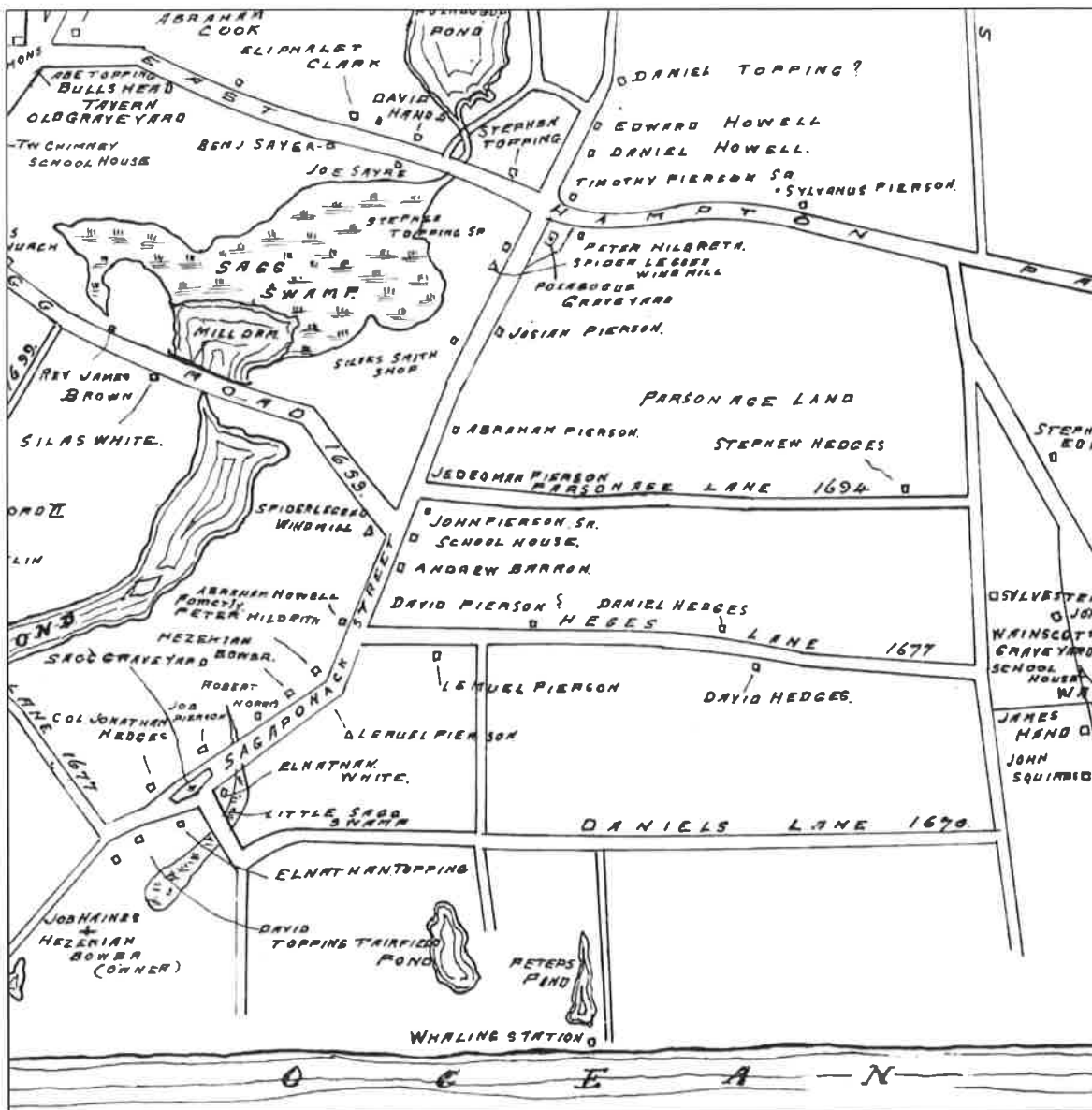

Detail, 1750 Map, from Sketches from Local History, by William Donaldson Halsey, 1935.

Village of Sagaponack  
 Inventory of Selected Historic Structures Outside the National Register Historic District  
 Sally Spanburgh – February 2017

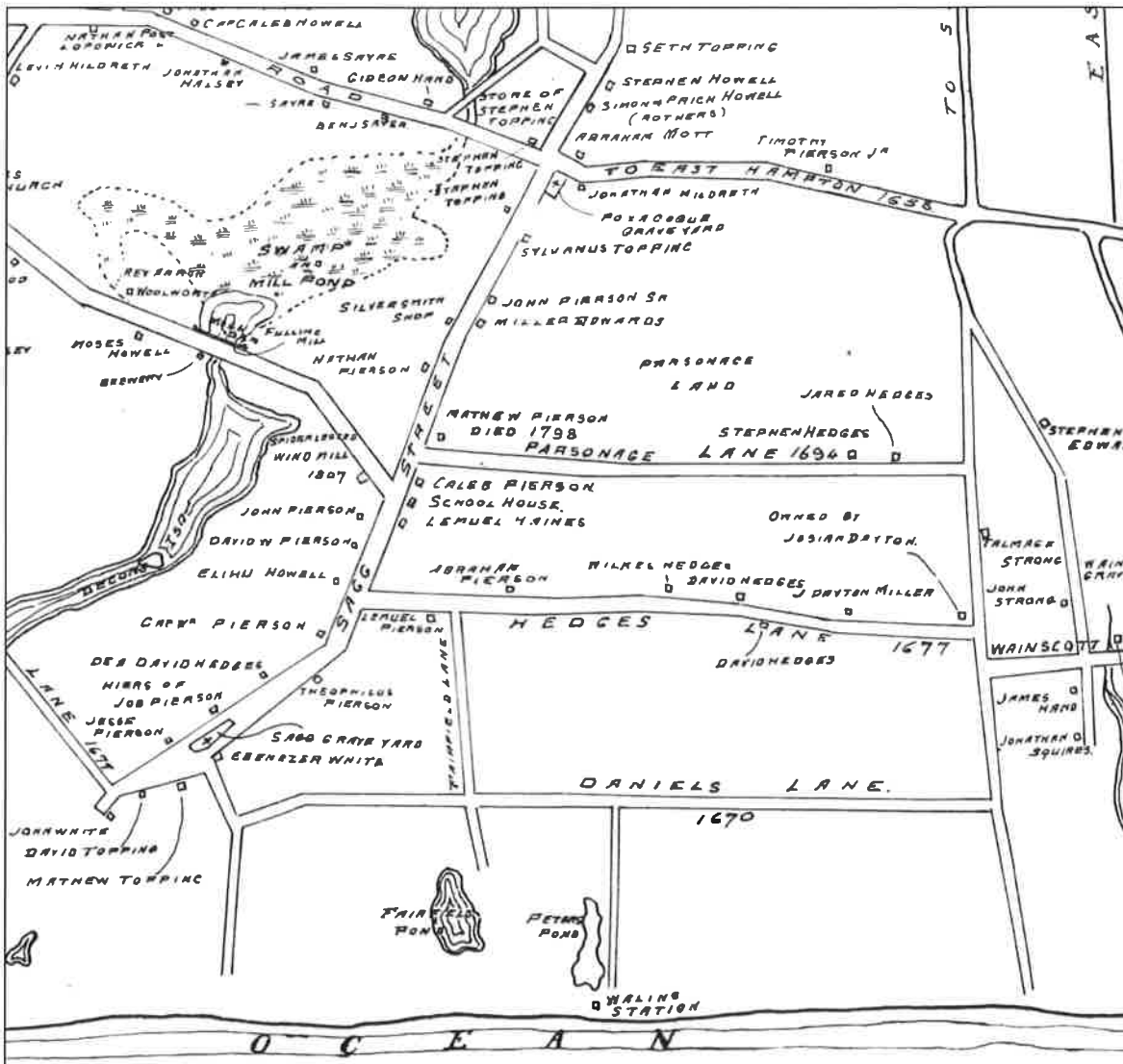

Detail, 1800 Map, from Sketches from Local History, by William Donaldson Halsey, 1935.

Village of Sagaponack  
 Inventory of Selected Historic Structures Outside the National Register Historic District  
 Sally Spanburgh – February 2017

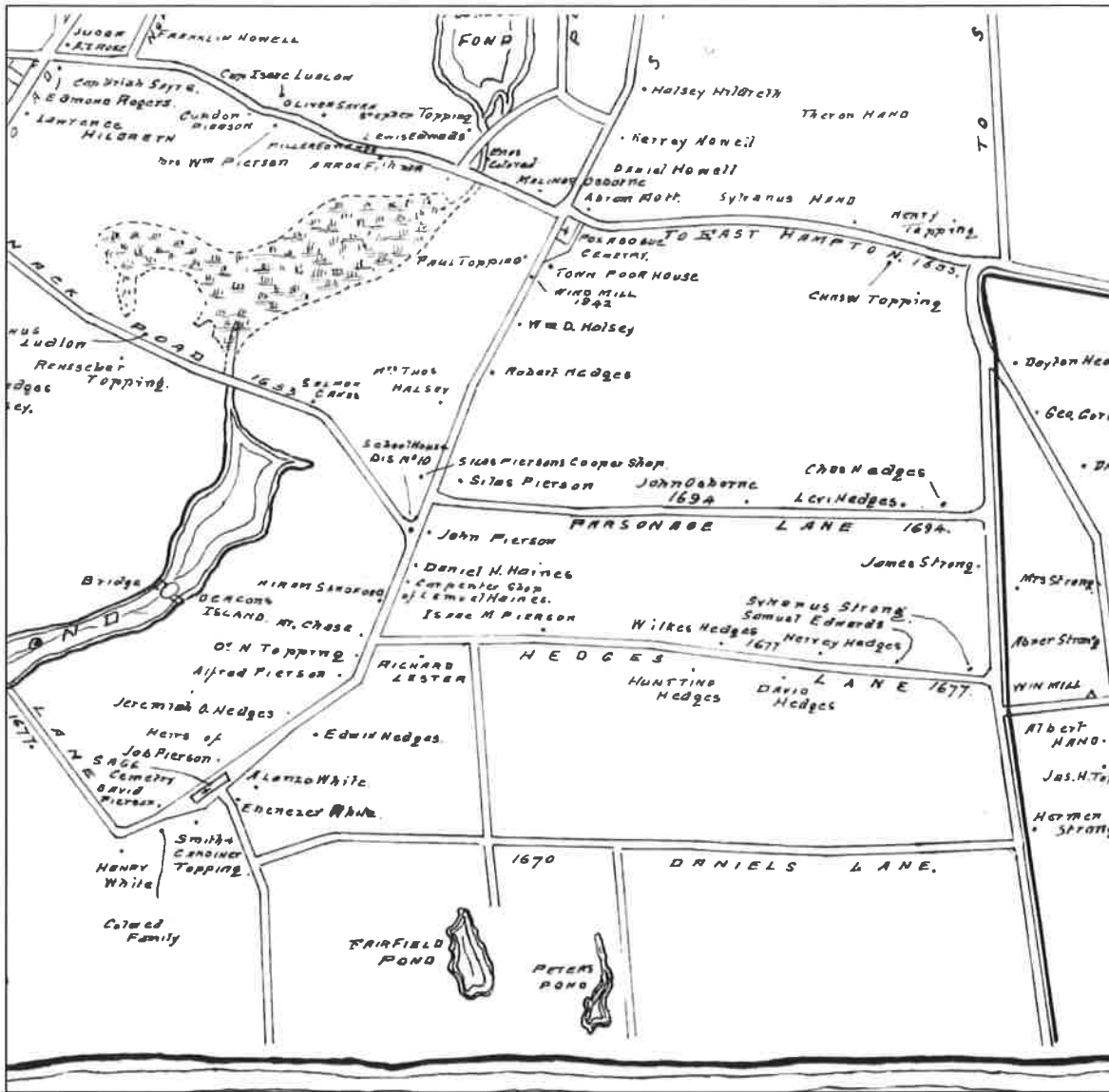

Detail, 1850 Map, from Sketches from Local History, by William Donaldson Halsey, 1935.





Village of Sagaponack  
Inventory of Selected Historic Structures Outside the National Register Historic District  
Sally Spanburgh – February 2017



Detail, Plate 188, Atlas of Long Island, Beers, Comstock & Cline, 1873.



Village of Sagaponack  
Inventory of Selected Historic Structures Outside the National Register Historic District  
Sally Spanburgh – February 2017



Detail, Atlas of Long Island, Plan of Southampton, F. W. Beers, 1894.

Village of Sagaponack  
Inventory of Selected Historic Structures Outside the National Register Historic District  
Sally Spanburgh – February 2017



Detail, Plate 6, Atlas of Suffolk County, Long Island, Vol. 1, Ocean Shore, E.  
Belcher & Hyde, 1902.



Village of Sagaponack  
Inventory of Selected Historic Structures Outside the National Register Historic District  
Sally Spanburgh – February 2017

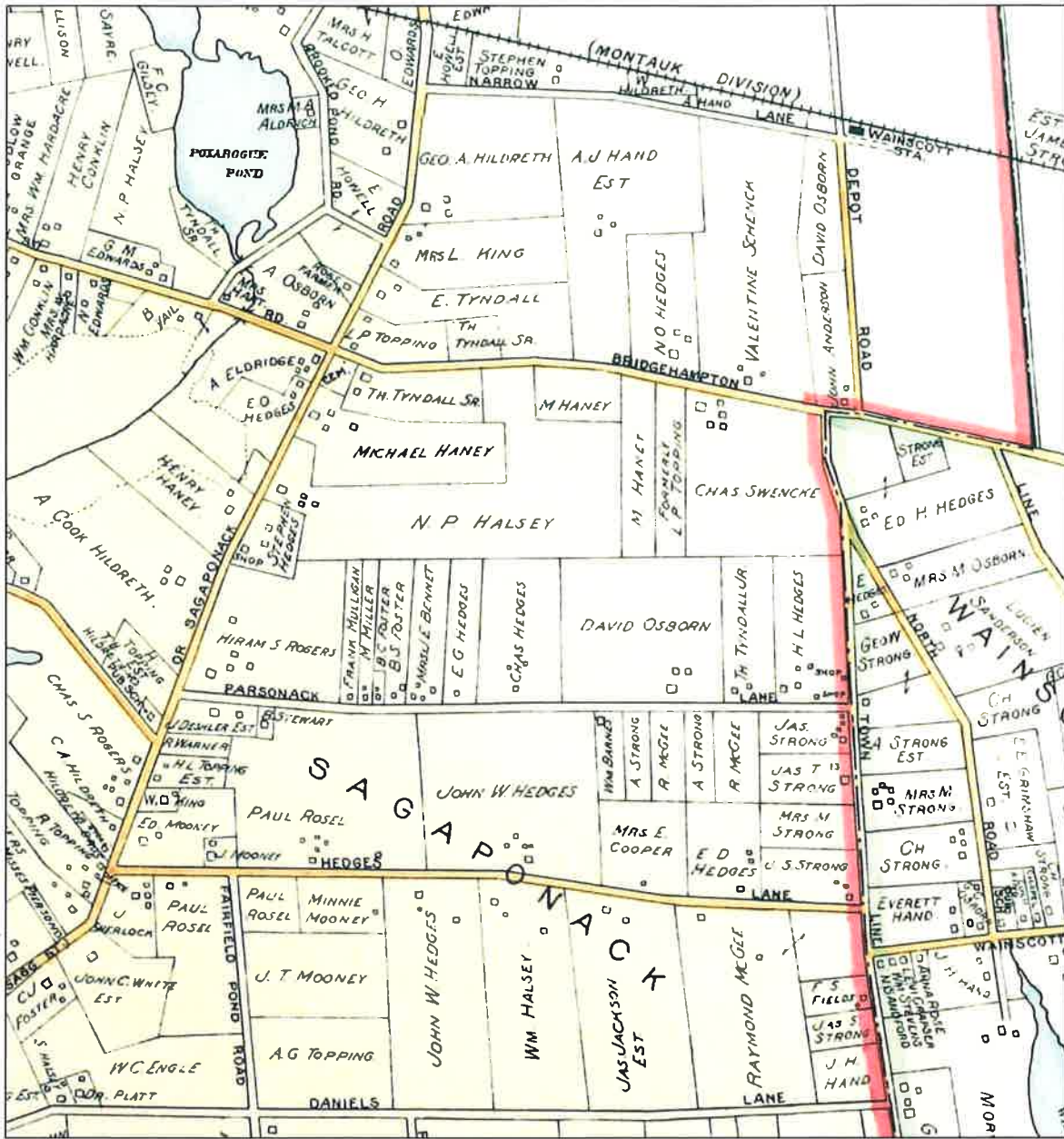

Detail, Plate 7, Atlas of a Part of Suffolk County, Long Island, New York, South Side – Ocean Shore, 1916, Vol. 2, E. Belcher & Hyde.



Village of Sagaponack  
**Inventory of Selected Historic Structures Outside the National Register Historic District**  
Sally Spanburgh – February 2017



*Detail, Plate sc193013g2, Long Island Black and White Aerials Collection, Stony Brook University.*

Village of Sagaponack

Inventory of Selected Historic Structures Outside the National Register Historic District

Sally Spanburgh – February 2017



Current Photo:

Property Name: Topping-Reed House

Approximate Year Built: 1730/1750

Property Street Address: 52 Sagaponack Main Street, Sagaponack, NY 11962

Suffolk County Tax Map Number: 908-1-4-9

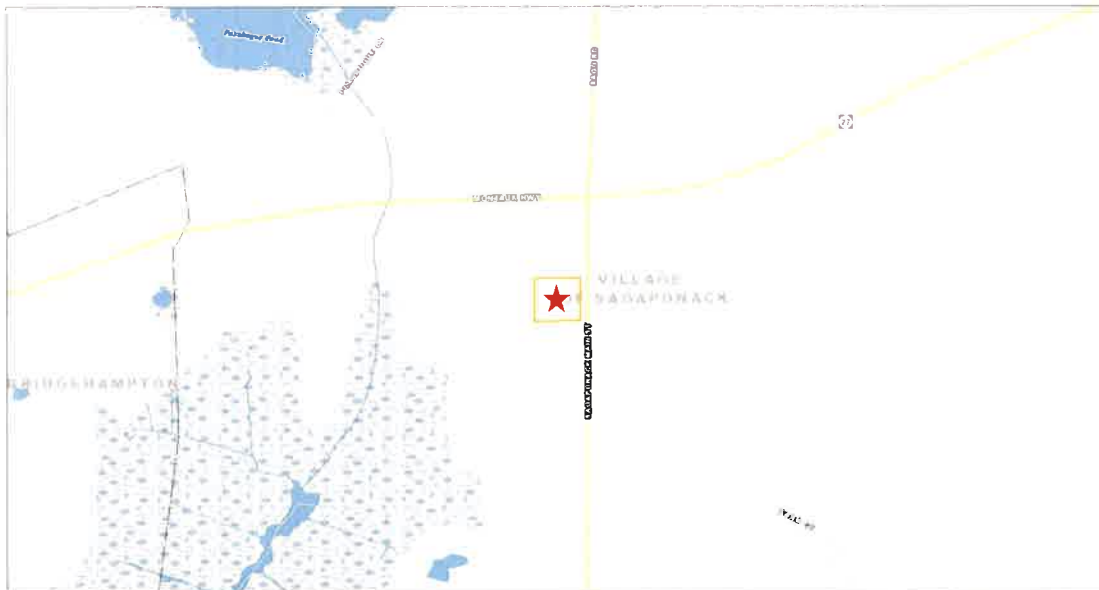

Locator Map:

**Inventory of Selected Historic Structures Outside the National Register Historic District**

Sally Spanburgh – February 2017

Historical Summary: "Stephen Topping built a house on the west side of Sagg Main almost to the corner about 1730. The house was a typical salt box."<sup>1</sup> "Then the Stephen Topping House, (later Paul Topping, later Elisha O. Hedges) in Poxabogue, built about 1750."<sup>2</sup> Stephen Topping (1703-1782) was a tanner. Upon his death he gave his homestead to his son, Charles Topping (1755-1823). Charles relocated to Onondaga County, New York and gave the property to his brother Henry Topping (1750-1812). Upon Henry's death, the property was obtained by Henry's son Paul Topping (1780-1847).

Ichabod Sheffield Seabury (1821-1907) was a well-known local architect and builder who built many area buildings such as the Prof. Lewis H. Hallock House (not extant) on Ocean Road, the Tiffany/Hendrickson House on Lumber Lane, the Bridgehampton Presbyterian Church, and the Bridgehampton Academy on Ocean Road (not extant).<sup>3</sup> "His father was Samuel A. Seabury who came to Sag Harbor and edited a paper, "The American Eagle." Later he moved to Huntington, L. I. and later to Stonington, Conn.....His mother was Julia Topping. When four years old his father died, and he went with his mother to live with her father, Matthew Topping, in Sagaponack. When 15 years and 10 months old, he went to sea with Capt. John Woodward, on the ship Concordia of Sag Harbor."<sup>4</sup> When Seabury was in his maturity, he wrote a letter as if 11 years old (1832), documenting the houses and area residents of Sagaponack as if on a walking tour, the entirety of which is printed in *Sketches from Local History*.

Elisha Osborne Hedges (1841-1930) was heavily involved in the early formation and years of the Bridgehampton Academy, served as secretary, treasurer and trustee of the Bridgehampton Methodist Church, clerk of the Sagaponack school district, secretary of the Southampton Democratic Party, and overseer of the Bridgehampton Grange.

The subject property is the site of a legal battle referred to as the "Sagg Mill Case" relating to a windmill built in the early 1700s and no longer extant. In the mid 1800s the windmill was moved to the street outside 52 Sagg Main Street. At that time Paul Topping lived in the subject home. "Topping forbade them to leave it there, but they paid no regard to his protests, and he, having no money to defend his rights, had to submit. Here it stood and was in actual use for about five years, when in 1842, Colonel Hervey Hedges, (the son-in-law of Paul Topping) furnished the necessary money, and Topping began suit...."<sup>5</sup> He won and the mill was torn down shortly afterwards. The suit was precedent setting with regards to the ownership of roads, it having been a common practice for property boundaries to extend to the middle of adjacent roadways.

**Architectural Description:**

Contributing south facing, three bay wide, two story tall timber frame home with saltbox profile and large brick center chimney. Clad in shingles with taller exposure on front (south) than sides and rear; corner boards. Center/front entry has two light transom and wide paneled surround. Windows are mostly original with multi-pane divided light patterns generally symmetrical in arrangement. East facing gable end window is not original, nor are skylights. A one story tall, one bay wide ell extends to

<sup>1</sup> *Sagaponack Then and Now*, Carolyn Halsey and Barbara Albright, editors, 2006.

<sup>2</sup> *Sketches from Local History*, William Donaldson Halsey, 1935.

<sup>3</sup> *Images of America: Bridgehampton*, by Geoffrey K. Fleming, 2003; and "Bridgehampton Hamlet Heritage Area Report," by Ann Sandford, 2009; and *Sketches from Local History*, William D. Halsey, 1935.

<sup>4</sup> *Sketches from Local History*, William D. Halsey, 1935.

<sup>5</sup> *ibid*



**Inventory of Selected Historic Structures Outside the National Register Historic District**

Sally Spanburgh – February 2017

the west and is a later addition. The home is in its original location and on its original foundation. Its east elevation is nicely visible from the street from the driveway openings but a view of its front/southern façade is not available. Additional landscaping/fencing along the street should be discouraged.



Google Map Aerial View:

Existing, Related, Contributing Accessory Structures: Yes (Well)

Historic Map References:

- 1700: "Stanish Topping"
- 1750: "Stephen Topping Sr."
- 1800: "Stephen Topping"
- 1850: "Paul Topping"
- 1858: "I. S. Seabury" (Ichabod Sheffield Seabury)
- 1873: "Jas. Topping" (Possibly Ichabod's mother's nephew, John James Topping (1841-1892); Ichabod's cousin.)
- 1894: "E. O. Hedges" (Elisha Osborne Hedges)
- 1902: "E. D. Hedges"
- 1916: "E. O. Hedges"

State/National Register Criteria:

The following criteria are used to evaluate properties for listing on the New York State and National Registers of Historic Places. (**Bolded** language is particularly relevant to the subject property.)

**The quality of significance in American history, architecture, archeology, engineering, and culture is present in districts, sites, buildings, structures, and objects that possess integrity of location, design, setting, materials, workmanship, feeling, and association, and:**

- a. **that are associated with events that have made a significant contribution to the broad patterns of our history; or**
- b. that are associated with the lives of persons significant in our past; or

**Inventory of Selected Historic Structures Outside the National Register Historic District**

Sally Spanburgh – February 2017

- c. **that embody the distinctive characteristics of a type, period, or method of construction, or that represent the work of a master, or that possess high artistic values, or that represent a significant distinguishable entity whose components may lack individual distinction; or**
- d. **that have yielded, or may be likely to yield, information important in prehistory or history.**

Village of Sagaponack Criteria: (Section 245-73 B (2) (d)):

(**Bolded** language is particularly relevant to the subject property.)

**[1] Possesses special character or historic or aesthetic interest or value as part of the cultural, political, economic or social history of the Village, region, state or nation; or**

[2] Is identified with historic personages or is the site of an historic event in the Village, state or nation; or

**[3] Embodies the distinguishing characteristics of a type, period, style or method of architecture or engineering; or**

[4] Is the work of an important builder, designer, artist or architect whose work has significantly influenced an age; or

**[5] Because of its unique location or singular physical characteristics or landscape, represents an established and familiar visual or aesthetic feature of the neighborhood; or**

[6] Is significant for containing elements of design, details, materials or craftsmanship which represent a significant innovation; or

**[7] Has special historical significance to the Village of Sagaponack, Town of Southampton, County of Suffolk, State of New York, or the United States of America by reason of famous events or the antiquity or uniqueness of architectural construction or design.**

Village of Sagaponack

Inventory of Selected Historic Structures Outside the National Register Historic District

Sally Spanburgh – February 2017



Current Photo:

Property Name: Topping-Neylon House	Approximate Year Built: 1800
Property Street Address: 65 Sagaponack Main Street, Sagaponack, NY 11962	
Suffolk County Tax Map Number: 908-4-1-5	



January 13, 2017

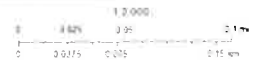

Locator Map:



**Inventory of Selected Historic Structures Outside the National Register Historic District**

Sally Spanburgh – February 2017

**Historical Summary:**

"On the east near to the Poxabogue Cemetery, Sylvanus Topping built a home c. 1800 and maintained a Poor House. Poor houses were set aside for the needy and for children whose parents were judged unable to care for them. These were established as early as 1750 in Southampton Town. The south wing of the Neylon house was part of the original Poor House."<sup>1</sup>

"The Town Poor farm was formerly owned by Sylvanus Topping. (1800). Sold after many years to Michael Haney, who tore down the older part of the house and retained the wing for a dwelling."<sup>2</sup> Sylvanus Topping (1735-1820): acquired the property, described as a "wood close", from his father about 1746.<sup>3</sup>

Michael Haney (1833-1906): Irish immigrant. Worked as farm labor for Alonzo White. Bought the Poor House Property in 1878 (encompassing 32 acres)<sup>4</sup> after Suffolk County opened the Almshouse in Yaphank about 1872.<sup>5</sup> The property was inherited by son Henry Haney (1867-1933) upon Michael Haney's death. It does not appear that Henry lived in the house but used it to house farm labor. The northern volume appears to have been built by Henry to expand the house to accommodate farm laborers, the George Williams family, in 1915. The northern volume was built for Henry by Stephen Hedges. The detached garage was built at the same time.<sup>6</sup> Henry's wife, Esther Rogers Haney (1886-aft.1936) appears to have rented the house out after Henry's death.

"Mr. and Mrs. John Neylon have moved into Mrs. Henry Haney's house on Sagaponack Road."<sup>7</sup>

**Architectural Description:**

**Southern volume:** Contributing ell of original home built on property in 1800 in original location. One story tall and one room deep with side facing gable roof. Original 1800s portion appears to include the entry and northern two windows, with corner boards. The southern portion, containing two windows, and the shed extension, are later 1800s additions. A brick chimney rises through the roof ridge. Clad in painted cedar shingles. Six-over-six double hung windows. Painted louvered shutters. Shed roof entry on brackets with dental molding. Wood stoop.

**Northern volume:** Contributing two-story farmhouse style built in 1915. Three bays wide. Front facing gable roof. Entry offset in southern bay. One bay wide shed roof entry porch with fretwork and paired turned posts. Double-hung windows with six-over-six divided light windows and painted louvered shutters symmetrically arranged. Clad in painted cedar shingles with corner boards.

The property is very visible to the public without screening/landscaping/fencing along the roadway.

<sup>1</sup> *Sagaponack Then and Now*, Carolyn Halsey and Barbara Albright, editors, 2006.

<sup>2</sup> *Sketches from Local History*, William D. Halsey, 1935.

<sup>3</sup> *Abstracts of Wills on File in the Surrogate's Office, City of New York*, Vol. IV, 1744-1753, published 1895.

<sup>4</sup> *Sag Harbor Express*, March 6, 1878

<sup>5</sup> Michael Haney obituary: *Sag Harbor Express*, Oct. 25, 1906.

<sup>6</sup> *East Hampton Star*, March 19, 1915.

<sup>7</sup> *East Hampton Star*, May 13, 1937.

## Inventory of Selected Historic Structures Outside the National Register Historic District

Sally Spanburgh – February 2017



Google Map Aerial View:

Existing, Related, Contributing Accessory Structures: Yes (Contributing Shed and Garage)

Historic Map References:

1800: "Sylvanus Topping"

1858: "Town Poor House"

1873: "Capt. E. Halsey"

1894: "M. Haney"

1902: "Michael Haney"

1916: "Michael Haney"

State/National Register Criteria:

The following criteria are used to evaluate properties for listing on the New York State and National Registers of Historic Places. (**Bolded** language is particularly relevant to the subject property.)

**The quality of significance in American history, architecture, archeology, engineering, and culture is present in districts, sites, buildings, structures, and objects that possess integrity of location, design, setting, materials, workmanship, feeling, and association, and:**

- a. **that are associated with events that have made a significant contribution to the broad patterns of our history;** or
- b. that are associated with the lives of persons significant in our past; or
- c. **that embody the distinctive characteristics of a type, period, or method of construction,** or that represent the work of a master, or that possess high artistic values, or that represent a significant distinguishable entity whose components may lack individual distinction; or
- d. that have yielded, or may be likely to yield, information important in prehistory or history.

**Inventory of Selected Historic Structures Outside the National Register Historic District**

Sally Spanburgh – February 2017

Village of Sagaponack Criteria: (Section 245-73 B (2) (d)):

(**Bolded** language is particularly relevant to the subject property.)

**[1] Possesses special character or historic or aesthetic interest or value as part of the cultural, political, economic or social history of the Village, region, state or nation; or**

[2] Is identified with historic personages or is the site of an historic event in the Village, state or nation; or

**[3] Embodies the distinguishing characteristics of a type, period, style or method of architecture or engineering; or**

[4] Is the work of an important builder, designer, artist or architect whose work has significantly influenced an age; or

**[5] Because of its unique location or singular physical characteristics or landscape, represents an established and familiar visual or aesthetic feature of the neighborhood; or**

[6] Is significant for containing elements of design, details, materials or craftsmanship which represent a significant innovation; or

**[7] Has special historical significance to the Village of Sagaponack, Town of Southampton, County of Suffolk, State of New York, or the United States of America by reason of famous events or the antiquity or uniqueness of architectural construction or design.**



Village of Sagaponack

Inventory of Selected Historic Structures Outside the National Register Historic District

Sally Spanburgh – February 2017



Current Photo:

Property Name: Mott-Topping House	Approximate Year Built: 1740
Property Street Address: 35 Sagg Road, Sagaponack, NY 11962	
Suffolk County Tax Map Number: 908-2-2-19	

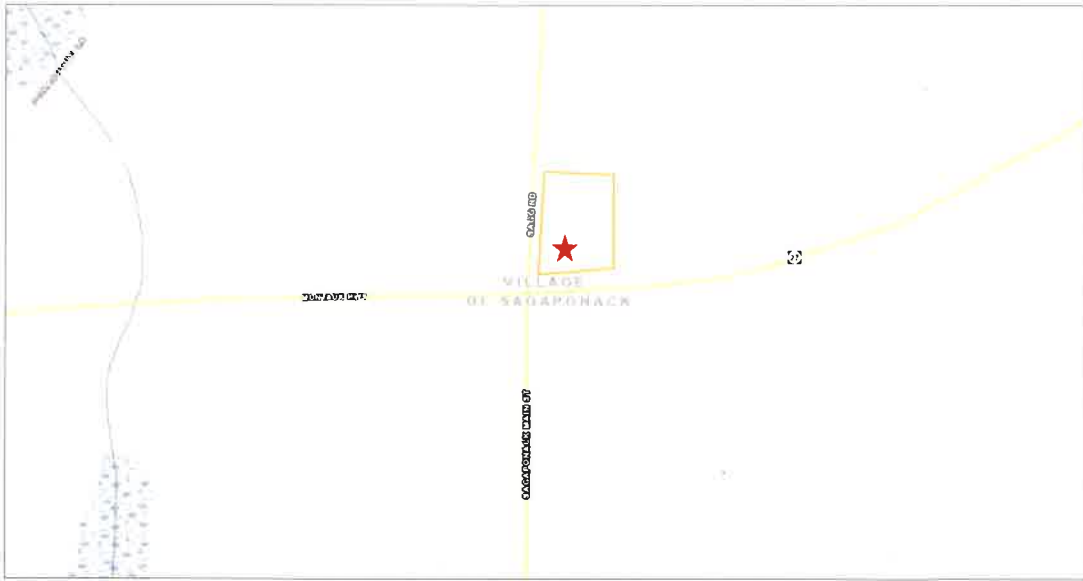

Locator Map:

## Inventory of Selected Historic Structures Outside the National Register Historic District

Sally Spanburgh – February 2017

Historical Summary: "North of "Kings Highway" [ed.--*Montauk Highway*] is a house built by Abraham Mott in 1740. There were cypress shingles on the sides and seaweed was used for insulation. L. P. Topping bought the house in the early 1870's. Fred Wilford remembers his great-grandfather maintained a small farm with cows, chickens, ducks and geese. He also raised vegetables and peddled them as well as eggs and chickens to the area estates by horse and wagon. Later on, strawberries were the main crop and were sold in front of the house. There were two coal stoves in the house, a cook stove in the kitchen and a fancy parlor stove, both of which heated the downstairs. The original lines of the house are pretty well kept including the 12 over 12 windows (sic) panes, but it is no longer a farm."<sup>1</sup>

"...John Wick...early kept the tavern at Bull Head, and there was another on the Mott corner at Poxabogue kept by a Gardiner family, while drink was also sold at stores in Sag and Mecox."<sup>2</sup>

"A suspicious looking craft hovered about the place for days with no apparent destination or purpose....When the vessel sunk in the depths of ocean....Boats, one or more, with their crews, were rowed from the sinking vessel, landed at Montauk Point, and the men leaving the boats made their way west and scattered in different directions. All the circumstances indicated the disbandment of a gang of Pirates, who had divided their plunder, scuttled their vessel and dispersed. One of this company wended his solitary way to the dwelling now of Leander P. Topping, then of Timothy Pierson, at Poxabogue, in Bridge-Hampton, and asked permission to sleep in his barn, which was granted. The dwelling yet stands a monument and memorial of enduring architecture unknown in these later days of ephemeral and balloon structures. Its front, with projecting eaves and cornice, presents even yet the aspect of a character of no common order. Its long, low, north roof denotes an age that numbers at least one, and probably nearly two centuries. It was supposed to have been built by one Gardiner, whose wife was daughter of the Edward Howell who first settled in Poxabogue soon after the year 1700. Before and during the Revolution it had been a tavern, and its rafters had rung with boisterous roar. Its history would measure and long antedate the war termed "French and Indian." Venerable for age, type of an era anterior to the memory of the living. Its early years are known by tradition and by that alone... The sailor, obtaining permission therefor, slept in the barn of Timothy Pierson. He was taken with some malady that was mortal, was cared for and taken to the house. He grew more deathly sick, and in his expiring struggle, with his fainting breath and latest utterance, slowly gasped his sense of gratitude in the words "I wear a belt," and then was gone...His body was buried in the old graveyard near by and rests in an unmarked and now an unremembered grave. Dark hints were spoken of a lantern seen at the grave in the night. Rumor spoke mysteriously of traces of exhumation noticed there and attributed them to searchers for the belt. When, not long after, Timothy Pierson built and inhabited a very large dwelling located next east of his former residence, and on the same side of the street, gossip still unsatisfied was unwilling to attribute his means to build to his mercantile success, and darkly and sneakingly insinuated that but for the contents of the Pirate's belt he could not have paid for it..."<sup>3</sup>

Timothy Pierson (1731-1802)

Abraham R. Mott (1749-1858)

Leander Page Topping (1851-1934): Deputy Sherriff in Bridgehampton, 1894; Truant Officer for Sagaponack School District, 1896. Ran for several Southampton Town positions, such as Constable, Commissioner of Highways, and Trustee.

<sup>1</sup> *Sagaponack Then and Now*, Carolyn Halsey and Barbara Albright, editors, 2006.

<sup>2</sup> *Memorials of Old Bridgehampton*, James Truslow Adams, 1916.

<sup>3</sup> "I Wear a Belt," *Sag Harbor Express*, May 27, 1897.

## Inventory of Selected Historic Structures Outside the National Register Historic District

Sally Spanburgh – February 2017

## Architectural Description:

Contributing timber frame residence in original location. Three bays wide, two stories tall, south facing, salt box form. Wood shingled roof, painted cedar shingle siding between cornerboards. Shingles on front and sides have different exposures. Front cornice emphasized with large dentil brackets. Twelve-over-twelve and nine-over-six divided light double-hung windows. Main entry and chimney are slightly off center to the east. Front porch appears to date to the late 1800s. Rear one-story ell extends to the north. Property is on a busy intersection and is therefore thickly screened along Montauk Highway with only marginal visibility to the public. Property is more visible to the public from the side/Sagg Road.



Google Map Aerial View:

Existing, Related, Contributing Accessory Structures: Yes (Barn/Garage)

## Historic Map References:

1750: "Timothy Pierson Sr."

1800: "Abraham Mott"

1850: "Abram Mott"

1858: "A. Mott"

1873: "N. Miller"

1894: "L. P. Topping" (Leander Page)

1902: "T. Topping"

1916: "L. P. Topping"

## State/National Register Criteria:

The following criteria are used to evaluate properties for listing on the New York State and National Registers of Historic Places. (**Bolded** language is particularly relevant to the subject property.)

**The quality of significance in American history, architecture, archeology, engineering, and culture is present in districts, sites, buildings, structures, and objects that possess integrity of location, design, setting, materials, workmanship, feeling, and association, and:**



## Village of Sagaponack

## Inventory of Selected Historic Structures Outside the National Register Historic District

Sally Spanburgh – February 2017

- a. that are associated with events that have made a significant contribution to the broad patterns of our history; or
- b. that are associated with the lives of persons significant in our past; or
- c. **that embody the distinctive characteristics of a type, period, or method of construction**, or that represent the work of a master, or that possess high artistic values, or that represent a significant distinguishable entity whose components may lack individual distinction; or
- d. **that have yielded, or may be likely to yield, information important in prehistory or history.**

Village of Sagaponack Criteria: (Section 245-73 B (2) (d)):

(**Bolded** language is particularly relevant to the subject property.)

**[1] Possesses special character or historic or aesthetic interest or value as part of the cultural, political, economic or social history of the Village, region, state or nation; or**

**[2] Is identified with historic personages or is the site of an historic event in the Village, state or nation; or**

**[3] Embodies the distinguishing characteristics of a type, period, style or method of architecture or engineering; or**

**[4] Is the work of an important builder, designer, artist or architect whose work has significantly influenced an age; or**

**[5] Because of its unique location or singular physical characteristics or landscape, represents an established and familiar visual or aesthetic feature of the neighborhood; or**

**[6] Is significant for containing elements of design, details, materials or craftsmanship which represent a significant innovation; or**

**[7] Has special historical significance to the Village of Sagaponack, Town of Southampton, County of Suffolk, State of New York, or the United States of America by reason of famous events or the antiquity or uniqueness of architectural construction or design.**

Village of Sagaponack

Inventory of Selected Historic Structures Outside the National Register Historic District

Sally Spanburgh – February 2017



Current Photo:

Property Name: Gabled House	Approximate Year Built: 1800/1900/2000
Property Street Address: 109 Sagg Road, Sagaponack, NY 11962	
Suffolk County Tax Map Number: 908-2-2-9	

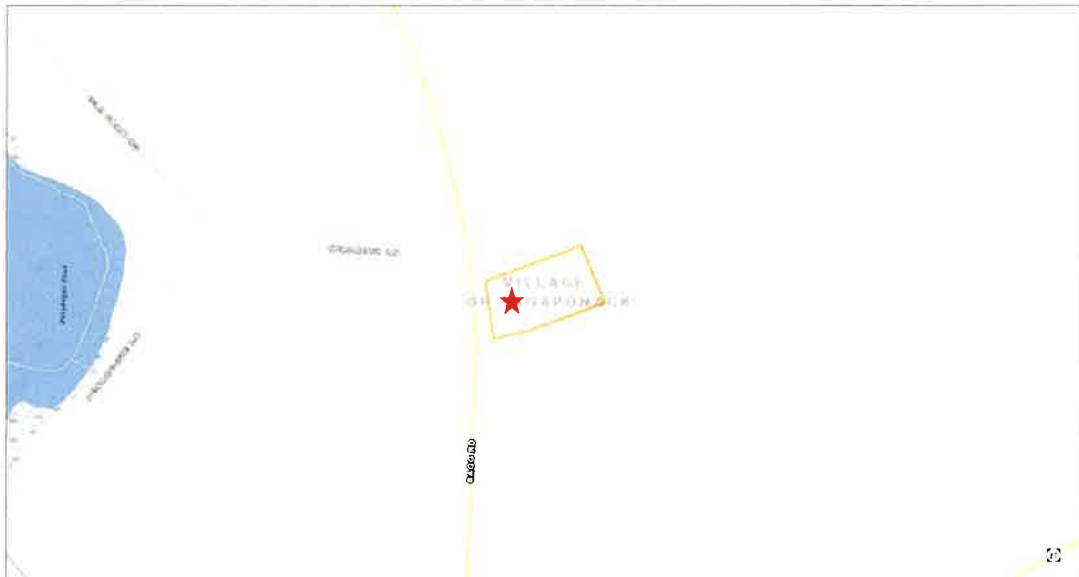

Locator Map:

**Inventory of Selected Historic Structures Outside the National Register Historic District**

Sally Spanburgh – February 2017

**Historical Summary:**

"The Edward Howell House and Tavern (which is shown on all maps except for the one for 1670) in Poxabogue, was built in the year 1690, was moved across the street to the west about 1875, and torn down in December 1931."<sup>1</sup>

"The Homestead containing twelve acres more or less, Bounded on the North by land of Jas. H. Hildreth; East by land formerly of J. S. Seabury; South by the Country Road and West by the Highway leading to Sag Harbor. On the premises are a comfortable two story Double House, Barn and Out Houses."<sup>2</sup>

"Edward Howell came in 1639 with his family to Boston, where he was made freeman, March 14, 1639-40. He soon removed to Lynn, where he had a grant of 500 acres. During the winter of 1639-40 a new settlement was projected on Long Island, of which he seems to have been the leader, as the compact or agreement of terms of founding the plantation is in his handwriting, as well as the laws adopted by the first settlers, and to the last year of his life he was always a magistrate and member of the colonial legislature at Hartford. The manner in which his name is mentioned in the colonial records of New England and New York point to the same conclusion."<sup>3</sup>

**Architectural Description:**

Despite the information above, based on historic maps, vintage aerial views, and building department information, a south-facing dwelling with center chimney and ridge oriented east-west, associated with Edward Howell and possibly dating to the 1700s, appears to have been joined between 1930-1962 with another home on the property that faced the street and had a north-south oriented ridge. It has since been significantly renovated. The original form of the first volume and the amount of surviving historic fabric overall is difficult to ascertain from the exterior.



Google Map Aerial View:

<sup>1</sup> *Sketches from Local History*, William Donaldson Halsey, 1935.

<sup>2</sup> *The Corrector*, October 19, 1867, in an advertisement placed by Phebe A. Mott for an auction, including other properties.

<sup>3</sup> *The Early History of Southampton, L.I., New York, with Genealogies*, George Rogers Howell, 1887.



## Village of Sagaponack

## Inventory of Selected Historic Structures Outside the National Register Historic District

Sally Spanburgh – February 2017

Existing, Related, Contributing Accessory Structures: No
<p>Historic Map References:</p> <p>1700: "Edward Howell"</p> <p>1750: "Edward Howell"</p> <p>1800: "Stephen Howell" (1759-1828)</p> <p>1850: "Hervey Howell" (1796-1880)</p> <p>1858: "H. Howell" (Hervey)</p> <p>1873: "E. Howell" (Edward; 1826-1905)</p> <p>1894: "E. Howell" (Edward)</p> <p>1902: "Ed. Howell" (Edward)</p> <p>1916: "Mrs. L. King" (Most likely a relative of Edward's wife, Julia Ann Conklin (1826-1904), who was previously married to Libbeus V. King (1822-1866) and had seven children with him.)</p>
<p>State/National Register Criteria:</p> <p>The following criteria are used to evaluate properties for listing on the New York State and National Registers of Historic Places. (<b>Bolded</b> language is particularly relevant to the subject property.)</p> <p>The quality of significance in American history, architecture, archeology, engineering, and culture is present in districts, sites, buildings, structures, and objects that possess integrity of location, design, setting, materials, workmanship, feeling, and association, and:</p> <ol style="list-style-type: none"> <li>a. that are associated with events that have made a significant contribution to the broad patterns of our history; or</li> <li>b. that are associated with the lives of persons significant in our past; or</li> <li>c. that embody the distinctive characteristics of a type, period, or method of construction, or that represent the work of a master, or that possess high artistic values, or that represent a significant distinguishable entity whose components may lack individual distinction; or</li> <li>d. that have yielded, or may be likely to yield, information important in prehistory or history.</li> </ol>
<p>Village of Sagaponack Criteria: (Section 245-73 B (2) (d)):</p> <p>(<b>Bolded</b> language is particularly relevant to the subject property.)</p> <p><b>[1] Possesses special character or historic or aesthetic interest or value as part of the cultural, political, economic or social history of the Village, region, state or nation; or</b></p> <p>[2] Is identified with historic personages or is the site of an historic event in the Village, state or nation; or</p> <p>[3] Embodies the distinguishing characteristics of a type, period, style or method of architecture or engineering; or</p> <p>[4] Is the work of an important builder, designer, artist or architect whose work has significantly influenced an age; or</p> <p>[5] Because of its unique location or singular physical characteristics or landscape, represents an established and familiar visual or aesthetic feature of the neighborhood; or</p> <p>[6] Is significant for containing elements of design, details, materials or craftsmanship which represent a significant innovation; or</p> <p>[7] Has special historical significance to the Village of Sagaponack, Town of Southampton, County of Suffolk, State of New York, or the United States of America by reason of famous events or the antiquity or uniqueness of architectural construction or design.</p>

**Inventory of Selected Historic Structures Outside the National Register Historic District**

Sally Spanburgh – February 2017



*Detail, Plate sc193013g1, Long Island Black and White Aerials Collection, Stony Brook University.*



*Detail 1962 Aerial, Suffolk County GIS Viewer, [www.suffolkcountyny.gov/gisviewer](http://www.suffolkcountyny.gov/gisviewer).*

**Inventory of Selected Historic Structures Outside the National Register Historic District**

Sally Spanburgh – February 2017



Current Photo:

Property Name: Hildreth-Wolffer House	Approximate Year Built: 1870
Property Street Address: 175 Sagg Road, Sagaponack, NY 11962	
Suffolk County Tax Map Number: 908-2-2-5	



Locator Map:



**Inventory of Selected Historic Structures Outside the National Register Historic District**

Sally Spanburgh – February 2017

Historical Summary: "The Seth Topping House (1800) Halsey Hildreth in 1850, was torn down about 1870, this was in Poxabogue."<sup>1</sup> The original house on the property was built for James Halsey Hildreth (1800-1874). It was likely built about 1830, around the time of his second marriage in 1829 to Mary Price Hand (his first wife, Elizabeth Howell (b.1900) died in 1827), and the subsequent birth of children beginning in 1830. The families of both wives had farms nearby. Thomas Hildreth was one of Southampton Town's earliest settlers, arriving about 1643. James Halsey Hildreth was a sixth generation descendant of Thomas.

**Architectural Description:**

The southernmost volume is a contributing Victorian style structure with Greek Revival details built on an earlier stone foundation in its original location. Two stories tall with front facing gable roof with triangle divided light window in the gable end and brick chimney rising through the center of the roof ridge. Three bays wide with the main entrance off set in the northern bay with elaborate surround and two light transom. Clad in cedar shingles with narrow corner boards and double hung windows with divided light patterns, most of which are modern replacement units. The home has been added onto and altered extensively and is heavily landscaped making public visibility extremely difficult.



Google Map Aerial View:

Existing, Related, Contributing Accessory Structures: Unknown. (There is an accessory structure, but it cannot be ascertained from a public right of way whether or not it is original to the site and to what degree it retains any original integrity.)

**Historic Map References:**

1700: Not present

1750: "Daniel Topping?"

1800: "Seth Topping"

1850: "Halsey Hildreth" (James Halsey)

1858: "J. H. Hildreth" (James Halsey)

<sup>1</sup> *Sketches from Local History*, William Donaldson Halsey, 1935.

## Inventory of Selected Historic Structures Outside the National Register Historic District

Sally Spanburgh – February 2017

1873: "G. Hildreth" (George Anson)  
 1894: "G. Hildreth" (George Anson)  
 1902: "Geo. Hildreth" (George Anson)  
 1916: "Geo. A. Hildreth" (George Anson)

## State/National Register Criteria:

The following criteria are used to evaluate properties for listing on the New York State and National Registers of Historic Places. (**Bolded** language is particularly relevant to the subject property.)

**The quality of significance in American history, architecture, archeology, engineering, and culture is present in districts, sites, buildings, structures, and objects that possess integrity of location, design, setting, materials, workmanship, feeling, and association, and:**

- a. that are associated with events that have made a significant contribution to the broad patterns of our history; or
- b. that are associated with the lives of persons significant in our past; or
- c. **that embody the distinctive characteristics of a type, period, or method of construction, or that represent the work of a master, or that possess high artistic values, or that represent a significant distinguishable entity whose components may lack individual distinction; or**
- d. that have yielded, or may be likely to yield, information important in prehistory or history.

## Village of Sagaponack Criteria: (Section 245-73 B (2) (d)):

(**Bolded** language is particularly relevant to the subject property.)

**[1] Possesses special character or historic or aesthetic interest or value as part of the cultural, political, economic or social history of the Village, region, state or nation; or**

**[2] Is identified with historic personages or is the site of an historic event in the Village, state or nation; or**

**[3] Embodies the distinguishing characteristics of a type, period, style or method of architecture or engineering; or**

**[4] Is the work of an important builder, designer, artist or architect whose work has significantly influenced an age; or**

**[5] Because of its unique location or singular physical characteristics or landscape, represents an established and familiar visual or aesthetic feature of the neighborhood; or**

**[6] Is significant for containing elements of design, details, materials or craftsmanship which represent a significant innovation; or**

**[7] Has special historical significance to the Village of Sagaponack, Town of Southampton, County of Suffolk, State of New York, or the United States of America by reason of famous events or the antiquity or uniqueness of architectural construction or design.**

**Inventory of Selected Historic Structures Outside the National Register Historic District**

Sally Spanburgh – February 2017



Current Photo:

Property Name: Talmadge Farmhouse	Approximate Year Built: 1905
Property Street Address: 218 Sagg Road, Sagaponack, NY 11962	
Suffolk County Tax Map Number: 908-1-2-25	

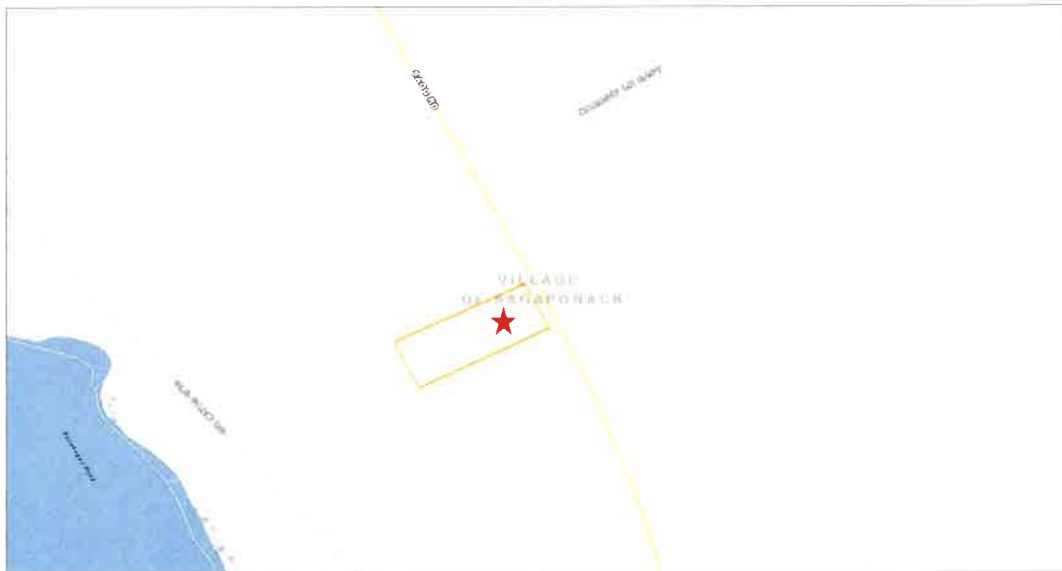

Locator Map:

**Inventory of Selected Historic Structures Outside the National Register Historic District**

Sally Spanburgh – February 2017

**Historical Summary:**

The subject house was built for George Halsey Hildreth (1873-1955), on property formerly owned by his father, grandfather, and great-grandfather. The home was likely built shortly after his marriage in 1903 to Frances Emma Mulligan (b.1880). George Halsey Hildreth was a son of George Anson Hildreth (1841-1916). George Halsey Hildreth was a farmer, a mason, a hunter, a trustee of the Sagaponack school, and a Southampton Town Commissioner of Highways. As a foreman of highways he was involved with the clearing, to some degree of Sagg Road and/or the road leading to the Wainscott train station.<sup>1</sup>

Thomas Hildreth was one of Southampton Town's earliest settlers, arriving about 1643. George Halsey Hildreth was an eighth generation descendant of Thomas. His daughter, Hazel Kirk Hildreth (1905-1979), married Albert M. Talmage (1905-1989). The Hildreth-Talmage family became the subsequent property owners.

**Architectural Description:**

Contributing two story vernacular Victorian farmhouse. Front facing gable roof with wrap-around one-story front porch with hipped roof supported by turned columns. North and south facing cross gables. Projected ornamental gable ends. Clad in cedar shingles with double hung [replacement] units symmetrically arranged. A brick chimney rises through the center of the main ridge. The property is able to be seen clearly from Sagg Road.



Google Map Aerial View:

Existing, Related, Contributing Accessory Structures: No

**Historic Map References:**

1858: Not present

1873: Not present

1894: Not present

1902: Not present, property owned by "Geo. Hildreth"

1916: "Geo. H. Hildreth"

<sup>1</sup> Various vintage newspaper references.



**Inventory of Selected Historic Structures Outside the National Register Historic District**  
Sally Spanburgh – February 2017

State/National Register Criteria:

The following criteria are used to evaluate properties for listing on the New York State and National Registers of Historic Places. (**Bolded** language is particularly relevant to the subject property.)

**The quality of significance in American history, architecture, archeology, engineering, and culture is present in districts, sites, buildings, structures, and objects that possess integrity of location, design, setting, materials, workmanship, feeling, and association, and:**

- a. that are associated with events that have made a significant contribution to the broad patterns of our history; or
- b. that are associated with the lives of persons significant in our past; or
- c. **that embody the distinctive characteristics of a type, period, or method of construction, or that represent the work of a master, or that possess high artistic values, or that represent a significant distinguishable entity whose components may lack individual distinction; or**
- d. that have yielded, or may be likely to yield, information important in prehistory or history.

Village of Sagaponack Criteria: (Section 245-73 B (2) (d)):

(**Bolded** language is particularly relevant to the subject property.)

**[1] Possesses special character or historic or aesthetic interest or value as part of the cultural, political, economic or social history of the Village, region, state or nation; or**

[2] Is identified with historic personages or is the site of an historic event in the Village, state or nation; or

**[3] Embodies the distinguishing characteristics of a type, period, style or method of architecture or engineering; or**

[4] Is the work of an important builder, designer, artist or architect whose work has significantly influenced an age; or

[5] Because of its unique location or singular physical characteristics or landscape, represents an established and familiar visual or aesthetic feature of the neighborhood; or

[6] Is significant for containing elements of design, details, materials or craftsmanship which represent a significant innovation; or

**[7] Has special historical significance to the Village of Sagaponack, Town of Southampton, County of Suffolk, State of New York, or the United States of America by reason of famous events or the antiquity or uniqueness of architectural construction or design.**

Village of Sagaponack

Inventory of Selected Historic Structures Outside the National Register Historic District

Sally Spanburgh – February 2017



Current Photo:

Property Name: Osborne-Rutkowski House	Approximate Year Built: 1895
Property Street Address: 444 Parsonage Lane, Sagaponack, NY 11962	
Suffolk County Tax Map Number: 908-4-3-37	



January 13, 2017

Locator Map:

**Inventory of Selected Historic Structures Outside the National Register Historic District**

Sally Spanburgh – February 2017

Historical Summary: "Also on the north side of Parsonage Lane, in 1880. John Osborne built a house. It is a shingled Victorian and has been known as the Rutkowski place."<sup>1</sup> According to historical maps and vintage newspaper articles, the subject home replaced an earlier home of 1852 that was relocated elsewhere and replaced with the present home.<sup>2</sup> The subject home was built for John Stratton Osborn II who was born and raised in Sag Harbor and relocated to Sagaponack about four years after marriage. It was built by his son, John Stratton Osborn Jr., who was a successful builder who lived in New Haven, Connecticut and visited Sagaponack frequently.<sup>3</sup>

John Stratton Osborn II (1818-1909)

David Oscar Osborn (1848-1924)

John Stratton Osborn Jr. (1852-1935)

**Architectural Description:**

Contributing two story tall, five bay wide Victorian home with side facing roof, twin internal brick chimneys, and front facing cross gable. Italianate, classical, and Gothic Revival influences. Character defining features include pedimented, engraved window trim, bracketed eave overhangs, and ornamental front facing cross gable with shingle patterning, fretwork, skirted second story, turned posts, and decorative fascia boards. The windows throughout the house appear to be replacement units. The large barn at the rear, and possibly other accessory structures, predate the residence. The property is able to be seen clearly from Parsonage Lane.



Google Map Aerial View:

Existing, Related, Contributing Accessory Structures: Yes (Barns, Garages, Cottages)

**Historic Map References:**

1800: Not present.

1850: "John Osborne"

<sup>1</sup> *Sagaponack Then and Now*, Carolyn Halsey and Barbara Albright, editors, 2006.

<sup>2</sup> *East Hampton Star*, May 3, 1895.

<sup>3</sup> *East Hampton Star*, March 15, 1895.

## Inventory of Selected Historic Structures Outside the National Register Historic District

Sally Spanburgh – February 2017

1858: "J. Osborn"  
 1873: "J. Osborn"  
 1894: "J. Osborn"  
 1902: "David Osborn"  
 1916: "David Osborn"

## State/National Register Criteria:

The following criteria are used to evaluate properties for listing on the New York State and National Registers of Historic Places. (**Bolded** language is particularly relevant to the subject property.)

**The quality of significance in American history, architecture, archeology, engineering, and culture is present in districts, sites, buildings, structures, and objects that possess integrity of location, design, setting, materials, workmanship, feeling, and association, and:**

- a. that are associated with events that have made a significant contribution to the broad patterns of our history; or
- b. that are associated with the lives of persons significant in our past; or
- c. **that embody the distinctive characteristics of a type, period, or method of construction, or that represent the work of a master, or that possess high artistic values, or that represent a significant distinguishable entity whose components may lack individual distinction; or**
- d. that have yielded, or may be likely to yield, information important in prehistory or history.

## Village of Sagaponack Criteria: (Section 245-73 B (2) (d)):

(**Bolded** language is particularly relevant to the subject property.)

**[1] Possesses special character or historic or aesthetic interest or value as part of the cultural, political, economic or social history of the Village, region, state or nation; or**

**[2] Is identified with historic personages or is the site of an historic event in the Village, state or nation; or**

**[3] Embodies the distinguishing characteristics of a type, period, style or method of architecture or engineering; or**

**[4] Is the work of an important builder, designer, artist or architect whose work has significantly influenced an age; or**

**[5] Because of its unique location or singular physical characteristics or landscape, represents an established and familiar visual or aesthetic feature of the neighborhood; or**

**[6] Is significant for containing elements of design, details, materials or craftsmanship which represent a significant innovation; or**

**[7] Has special historical significance to the Village of Sagaponack, Town of Southampton, County of Suffolk, State of New York, or the United States of America by reason of famous events or the antiquity or uniqueness of architectural construction or design.**



8  
Village of Sagaponack  
Inventory of Selected Historic Structures Outside the National Register Historic District  
Sally Spanburgh – February 2017



Current Photo:

Property Name: Hedges House	Approximate Year Built: 1842
Property Street Address: 243 Hedges Lane, Sagaponack, NY 11962	
Suffolk County Tax Map Number: 908-6-3-41	

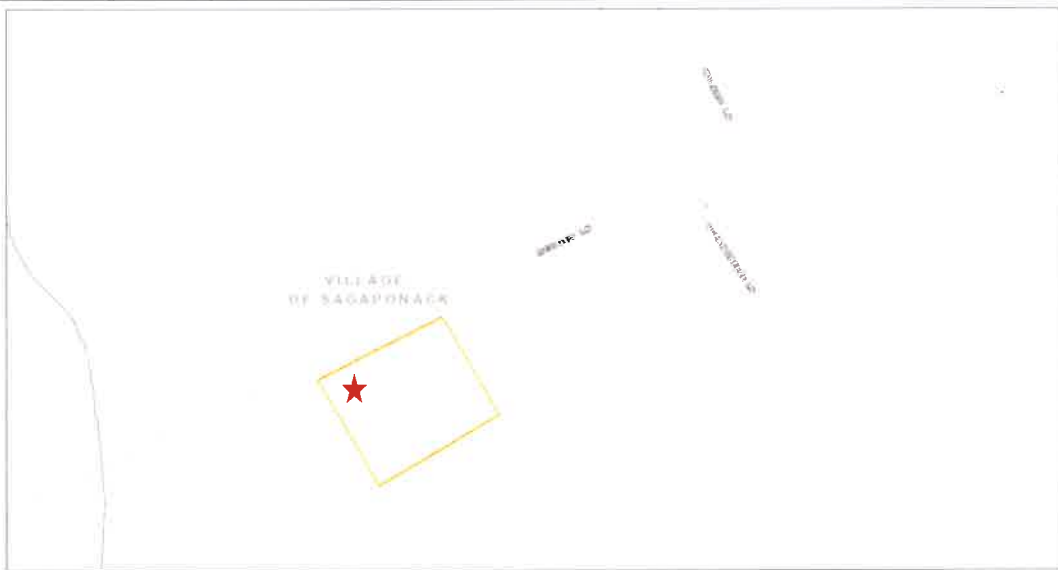

January 13, 2017

Locator Map:

**Inventory of Selected Historic Structures Outside the National Register Historic District**

Sally Spanburgh – February 2017

Historical Summary: "Then came Wilkes Hedges. His son Wilkes had the old place [ed.- #414 Hedges Lane] and his brother Huntting built his house in 1842."<sup>1</sup> [ed.- #243 Hedges Lane]

Huntting Miller Hedges (1808-1872; no children)

John Norris Hedges Jr. II (1848-aft. 1930; his father, Jared, was Huntting Miller's cousin)

John Wilkes Hedges (1843-1917; cousin to John Norris Hedges Jr. II)

**Architectural Description:**

Contributing one-and-a-half story Greek Revival style home in original location, with front facing gable roof and one story wing that extends to the side/east. Greek Revival style details include wide frieze boards supported by wide pilasters at the front façade corners, cornice returns at the gable ends and classical door surround. The home functions as a guest cottage now and has been renovated. Siding, roofing, trim, door, transom, and windows are contemporary, skylights are on the east side of the main roof, and a brick chimney on the west side of the house is not original. Front of house is openly visible to the public with the front property line enclosed with a low picket fence.



Google Map Aerial View:

Existing, Related, Contributing Accessory Structures: No

**Historic Map References:**

1800: not present

1850: Huntting Hedges (Huntting Miller)

1858: "H. M. Hedges" (Huntting Miller)

1873: Present, no name.

1894: "J. N. Hedges" (John Norris)

1902: "John W. Hedges" (John Wilkes)

1916: "John W. Hedges" (John Wilkes)

<sup>1</sup> *Sketches from Local History*, William Donaldson Halsey, 1935.

**Inventory of Selected Historic Structures Outside the National Register Historic District**

Sally Spanburgh – February 2017

## State/National Register Criteria:

The following criteria are used to evaluate properties for listing on the New York State and National Registers of Historic Places. (**Bolded** language is particularly relevant to the subject property.)

**The quality of significance in American history, architecture, archeology, engineering, and culture** is present in districts, sites, buildings, structures, and objects that possess **integrity of location, design, setting, materials, workmanship, feeling, and association**, and:

- a. that are associated with events that have made a significant contribution to the broad patterns of our history; or
- b. that are associated with the lives of persons significant in our past; or
- c. **that embody the distinctive characteristics of a type, period, or method of construction**, or that represent the work of a master, or that possess high artistic values, or that represent a significant distinguishable entity whose components may lack individual distinction; or
- d. that have yielded, or may be likely to yield, information important in prehistory or history.

## Village of Sagaponack Criteria: (Section 245-73 B (2) (d)):

(**Bolded** language is particularly relevant to the subject property.)

**[1] Possesses special character or historic or aesthetic interest or value as part of the cultural, political, economic or social history of the Village, region, state or nation; or**

[2] Is identified with historic personages or is the site of an historic event in the Village, state or nation; or

**[3] Embodies the distinguishing characteristics of a type, period, style or method of architecture or engineering; or**

[4] Is the work of an important builder, designer, artist or architect whose work has significantly influenced an age; or

[5] Because of its unique location or singular physical characteristics or landscape, represents an established and familiar visual or aesthetic feature of the neighborhood; or

[6] Is significant for containing elements of design, details, materials or craftsmanship which represent a significant innovation; or

**[7] Has special historical significance to the Village of Sagaponack, Town of Southampton, County of Suffolk, State of New York, or the United States of America by reason of famous events or the antiquity or uniqueness of architectural construction or design.**

Village of Sagaponack

Inventory of Selected Historic Structures Outside the National Register Historic District

Sally Spanburgh – February 2017



Current Photo:

Property Name: Deacon David Hedges House	Approximate Year Built: 1775
Property Street Address: 414 Hedges Lane, Sagaponack, NY 11962	
Suffolk County Tax Map Number: 908-6-3-25	



January 13 2017

Locator Map:



**Inventory of Selected Historic Structures Outside the National Register Historic District**

Sally Spanburgh – February 2017

Historical Summary: "In 1750 Daniel Hedges built a house on the north side of Hedges Lane. Still standing and in the Hedges family it is in good repair complete with the horse block on the edge of the road."<sup>1</sup> "Deacon David Hedges was a remarkable man. He served for 20 years as Supervisor in Southampton Town; was deputy to the 4<sup>th</sup> Provincial Congress, State of New York, 1776-77; delegate to the Convention that ratified the Constitution of the U.S., and voting therefor; Member of Assembly, 1786, '87, '88, '89, 1804, '06, and '07. In 1807 he was active in securing passage of an act incorporating the Proprietors of Montauk, a complicated business which met with some opposition...During the Revolution the Bridgehampton Church had no minister; then and often in later life in the minister's absence he would conduct public worship and read a sermon...Deacon David Hedges built the house on Hedges Lane, Sagaponack, - a street that was once all Hedges houses - which was owned by the late Samuel C. Hedges of East Hampton. Last of the name to live there were the Misses Esther and Ann Hedges, 8<sup>th</sup> generation...Deacon David...could walk from Sagg to Wainscott on his own land. When he was away at the Legislature he left his slaves to manage the place. He had a big family of slaves, descendants of one Adam who came as a child of 5 from the Congo; five children were born to him on the place and Miss Hedges father built a house for his son John who drove their oxen when she was a child. The slaves were liberated in 1828, she said. Wilkes Hedges' Bible recorded births of three slaves - John, in May 1801; "Vilet," May, 1803; and Kingston July 30, 1805."<sup>2</sup>

"The family of Hedges is an old and prominent one in the East, and its members, in different generations, ave, in one way and another, become quite well known...The first of the name to come hither was William Hedges, who emigrated from England in 1639, and purchased a tract of land in East Hampton, L.I., where he passed the remainder of his days. His son, Stephen, and grandson, Daniel, and great-grandson, Daniel, Jr., were born on Long Island, as was also the son of the latter, David...whose birth occurred in 1744. A man of prominence and influence, David Hedges was for fifty years a Deacon in the Presbyterian Church. He was a member of the Colonial Congress that convened at Kingston, and was a member of the convention of the state of New York which ratified the Constitution of the United States. For twenty-two years he was Supervisor, which is a longer period than any other man has ever held that office in the town of Southampton. For seven or eight sessions he was a member of the Assembly of the state of New York. By occupation he was a farmer, and in that occupation, as in public affairs, was noted for his great executive capacity. In 1777, when Sag Harbor was occupied by the British, he was coerced to furnish a large supply of hay for the army."<sup>3</sup>

Daniel Hedges (1709-1766)

Deacon David Hedges (1744-1817); son of Daniel

Wilkes Hedges (1775-1849); son of David

Wilkes Hedges II (1811-1885); son of Wilkes

John Wilkes Hedges (1843-1917); son of Wilkes II

**Architectural Description:**

Contributing timber frame residence in its original location. Five bays wide, two stories tall, with center entry and twin internal chimneys. Front entry has three light transom and paneled door surrounded by tall crown with dentil molding supported by flat pilasters. Front eave also decorated with dentil molding. Many, but not all of the original double-hung windows with multi-light patterns were replaced with Victorian two-over-two windows. (Among surviving windows are two on the rear elevation of the main volume: a 15 over 15 light unit and a 9 over 6 light unit.) Clad in cedar shingles

<sup>1</sup> *Sagaponack Then and Now*, Carolyn Halsey and Barbara Albright, editors, 2006.

<sup>2</sup> *East Hampton History: Including Genealogies of Early Families*, Jeannette Rattray, 1953.

<sup>3</sup> *Portrait and Biographical Record of Suffolk County, (Long Island) New York*, Chapman Publishing Co., 1896.

## Inventory of Selected Historic Structures Outside the National Register Historic District

Sally Spanburgh – February 2017

with tall exposure on main volume and corner boards; windows and doors symmetrically arranged. There is a one-story wing to the west, a one-and-a-half story wing to the east and a two story rear ell. The rear ell is said to have been built in the 1920s but there is ample visible evidence suggesting an earlier date. The birth and death dates of Deacon David Hedges and the twin internal symmetrical chimneys support a 1775 construction date. An interior tour of the home by the author of this report, in April of 2016, confirmed the presence of slaves and witnessed an overall museum-like quality of architecture complete with a spinning wheel in the attic. Per historical maps, the home may have taken the place of, consumed, or consists of an earlier residence.



Google Map Aerial View:

Existing, Related, Contributing Accessory Structures: Yes (Barn and Chicken Coops)

## Historic Map References:

1700: "Daniel Hedges"

1750: "Daniel Hedges"

1800: "David Hedges"

1850: unclear

1858: "J. W. Hedges"

1873: "W. Hedges"

1894: "J. N. Hedges"

1902: "J. W. Hedges"

1916: "John W. Hedges"

## State/National Register Criteria:

The following criteria are used to evaluate properties for listing on the New York State and National Registers of Historic Places. (**Bolded** language is particularly relevant to the subject property.)

**The quality of significance in American history, architecture, archeology, engineering, and culture** is present in districts, sites, buildings, structures, and objects that possess **integrity of location, design, setting, materials, workmanship, feeling, and association**, and:

- a. **that are associated with events that have made a significant contribution to the broad patterns of our history; or**

## Inventory of Selected Historic Structures Outside the National Register Historic District

Sally Spanburgh – February 2017

- b. that are associated with the lives of persons significant in our past; or
- c. that embody the distinctive characteristics of a type, period, or method of construction, or that represent the work of a master, or that possess high artistic values, or that represent a significant distinguishable entity whose components may lack individual distinction; or
- d. that have yielded, or may be likely to yield, information important in prehistory or history.

Village of Sagaponack Criteria: (Section 245-73 B (2) (d)):

(**Bolded** language is particularly relevant to the subject property.)

**[1] Possesses special character or historic or aesthetic interest or value as part of the cultural, political, economic or social history of the Village, region, state or nation; or**

**[2] Is identified with historic personages or is the site of an historic event in the Village, state or nation; or**

**[3] Embodies the distinguishing characteristics of a type, period, style or method of architecture or engineering; or**

**[4] Is the work of an important builder, designer, artist or architect whose work has significantly influenced an age; or**

**[5] Because of its unique location or singular physical characteristics or landscape, represents an established and familiar visual or aesthetic feature of the neighborhood; or**

**[6] Is significant for containing elements of design, details, materials or craftsmanship which represent a significant innovation; or**

**[7] Has special historical significance to the Village of Sagaponack, Town of Southampton, County of Suffolk, State of New York, or the United States of America by reason of famous events or the antiquity or uniqueness of architectural construction or design.**



*Early photo Deacon Hedges Homestead. Courtesy of the Bridgehampton Historical Society.*

Vintage Imagery: (from *Sagaponack Then and Now*); note early color scheme.

10  
Village of Sagaponack  
Inventory of Selected Historic Structures Outside the National Register Historic District  
Sally Spanburgh – February 2017



Current Photo:

Property Name: Hedges-Musnicki-Galban House	Approximate Year Built: 1830
Property Street Address: 453 Hedges Lane, Sagaponack, NY 11962	
Suffolk County Tax Map Number: 908-7-1-25	



January 13, 2017

Locator Map:



**Inventory of Selected Historic Structures Outside the National Register Historic District**

Sally Spanburgh – February 2017

**Historical Summary:**

"David Hedges of Sagaponack was the 7<sup>th</sup> generation of that family in this country, and lived on the south side of Hedges Lane...He was a prosperous farmer, and one source of income each year was a fine lot of pigs."<sup>1</sup> David Hedges (1802-about 1870) was a great-grandson of Daniel Hedges who came to Sagaponack from East Hampton in 1702.<sup>2</sup> Daniel was a descendant of William Hedges, the first of the family to arrive in Southampton in 1644. Cassander White Hedges (1834-1911) inherited the subject property from his father, David, about 1870 and sold it in 1887 for \$7,750 to Joseph C. Jackson of New York and John C. Orrick of Missouri. As of 1946 the property was owned solely by the Jackson family. In 1962 it was sold to Mary, Bertha, and Pauline Musnicki who had been leasing the property since before 1926; the Musnicki family farmed the property for the Hedges family since the early 1900s, when Mary, Bertha, and Pauline's parents emigrated to America from [Russian] Poland<sup>3</sup>; pigs, potatoes and cattle were cultivated. Musnicki ownership ended in 1985.<sup>4</sup>

**Architectural Description:**

Contributing Greek Revival style home in its original location with early Italianate influences. Three bay wide, two story tall main volume with side facing gable roof and cornice/eave lines emphasized with wide bands of trim and profiled brackets. Main front six panel entrance door set in western bay, with Greek Revival transom and elaborate door surround. Brick internal chimney rises through eastern bay through front half of house's two room depth. One story wing extends to the east with shed roof (sloping down toward the rear) and front elevation with bracketed cornice that appears almost parapet-like, as if it may have functioned at one time as a store. One-and-a-half long rear ell with brick chimney through the ridge at the mid-point. Painted clapboard siding with corner boards and double-hung [mostly replacement] window units with [mostly] six-over-six divided light patterns symmetrically arranged. The home may have taken the place of, consumed, or consists of an earlier residence. Property remains visible to the public; street-front lined with white painted low picket fence.

<sup>1</sup> *Sketches from Local History*, William D. Halsey, 1935.

<sup>2</sup> *The Early History of Southampton, L.I., New York, with Genealogies*, George R. Howell, 1887.

<sup>3</sup> U.S. census data.

<sup>4</sup> Ownership history courtesy of The Bridgehampton Museum.

## Inventory of Selected Historic Structures Outside the National Register Historic District

Sally Spanburgh – February 2017



Google Map Aerial View:

Existing, Related, Contributing Accessory Structures: Yes (two large barns and at least two other smaller accessory buildings.)

## Historic Map References:

1750: "David Hedges"  
 1800: "David Hedges"  
 1850: "David Hedges"  
 1858: "D. Hedges" (David)  
 1873: "C. Hedges" (Cassander)  
 1894: "Jackson" (Joseph Cooke)  
 1902: "Jas. Jackson Est."  
 1916: "Jas. Jackson Est."

## State/National Register Criteria:

The following criteria are used to evaluate properties for listing on the New York State and National Registers of Historic Places. (**Bolded** language is particularly relevant to the subject property.)

**The quality of significance in American history, architecture, archeology, engineering, and culture is present in districts, sites, buildings, structures, and objects that possess integrity of location, design, setting, materials, workmanship, feeling, and association, and:**

- a. **that are associated with events that have made a significant contribution to the broad patterns of our history; or**
- b. that are associated with the lives of persons significant in our past; or

**Inventory of Selected Historic Structures Outside the National Register Historic District**

Sally Spanburgh – February 2017

- c. **that embody the distinctive characteristics of a type, period, or method of construction**, or that represent the work of a master, or that possess high artistic values, or that represent a significant distinguishable entity whose components may lack individual distinction; or
- d. that have yielded, or may be likely to yield, information important in prehistory or history.

Village of Sagaponack Criteria: (Section 245-73 B (2) (d)):

(**Bolded** language is particularly relevant to the subject property.)

**[1] Possesses special character or historic or aesthetic interest or value as part of the cultural, political, economic or social history of the Village, region, state or nation; or**

[2] Is identified with historic personages or is the site of an historic event in the Village, state or nation; or

**[3] Embodies the distinguishing characteristics of a type, period, style or method of architecture or engineering; or**

[4] Is the work of an important builder, designer, artist or architect whose work has significantly influenced an age; or

[5] Because of its unique location or singular physical characteristics or landscape, represents an established and familiar visual or aesthetic feature of the neighborhood; or

[6] Is significant for containing elements of design, details, materials or craftsmanship which represent a significant innovation; or

**[7] Has special historical significance to the Village of Sagaponack, Town of Southampton, County of Suffolk, State of New York, or the United States of America by reason of famous events or the antiquity or uniqueness of architectural construction or design.**

11  
Village of Sagaponack  
Inventory of Selected Historic Structures Outside the National Register Historic District  
Sally Spanburgh – February 2017



Current Photo:

Property Name: Sylvanus Strong-Bennett House	Approximate Year Built: 1775
Property Street Address: 700 Hedges Lane, Sagaponack, NY 11962	
Suffolk County Tax Map Number: 908-7-2-26	



Locator Map:



**Inventory of Selected Historic Structures Outside the National Register Historic District**

Sally Spanburgh – February 2017

Historical Summary: "On the north west corner was a home built by Sylvanus Strong c.1850, another in the half house style that was so common in that day."<sup>1</sup> According to historic maps and the home's architectural style, it was more likely built for Josiah Dayton between 1750-1800.

Josiah Dayton (1766-abt.1839), of East Hampton.

Sylvanus Strong (1793-1872

John Strong (1827-1895), son of Sylvanus.

James S. Strong (1863-abt.1945), John was his father's cousin.

**Architectural Description:**

Contributing Georgian style half house in original location on stone foundation. Original main volume faces street/south; three bays wide with main entry off set in western bay with elaborate door surround and transom window. Two stories tall, two rooms deep, with brick chimney rising through ridge of eastern bay. Front eave line decorated with heavy dentil molding. One-story porch extends on the east side and has since been enclosed. Two story modern addition extends to the west from the rear ell designed to match the style and aesthetic detailing of the surviving historic volume (to the extent that it could be mistaken as older than it is). Clad in cedar shingles with corner boards and multi-light divided light double hung windows symmetrically arranged. Property is nicely visible to the public with little landscape screening along front/Hedges Lane and a white painted picket fence enclosure.



Google Map Aerial View:

Existing, Related, Contributing Accessory Structures: Yes (Barn/Garage).

**Historic Map References:**

1750: not present

1800: "Owned by Josiah Dayton" – structure present.

1850: "Sylvanus Strong"

1858: "S. Strong" (Sylvanus)

<sup>1</sup> *Sagaponack Then and Now*, Carolyn Halsey and Barbara Albright, editors, 2006.

**Inventory of Selected Historic Structures Outside the National Register Historic District**

Sally Spanburgh – February 2017

<p>1873: "J. Strong" (John)                  1894: "J. Strong" (John)                  1902: "J. S. Strong" (James)                  1916: "J. S. Strong"</p>
<p>State/National Register Criteria:                  The following criteria are used to evaluate properties for listing on the New York State and National Registers of Historic Places. (<b>Bolded</b> language is particularly relevant to the subject property.)</p> <p><b>The quality of significance in American history, architecture, archeology, engineering, and culture is present in districts, sites, buildings, structures, and objects that possess integrity of location, design, setting, materials, workmanship, feeling, and association, and:</b></p> <ul style="list-style-type: none"> <li>a. that are associated with events that have made a significant contribution to the broad patterns of our history; or</li> <li>b. that are associated with the lives of persons significant in our past; or</li> <li>c. <b>that embody the distinctive characteristics of a type, period, or method of construction, or that represent the work of a master, or that possess high artistic values, or that represent a significant distinguishable entity whose components may lack individual distinction; or</b></li> <li>d. <b>that have yielded, or may be likely to yield, information important in prehistory or history.</b></li> </ul>
<p>Village of Sagaponack Criteria: (Section 245-73 B (2) (d)):                  (<b>Bolded</b> language is particularly relevant to the subject property.)</p> <ul style="list-style-type: none"> <li><b>[1] Possesses special character or historic or aesthetic interest or value as part of the cultural, political, economic or social history of the Village, region, state or nation; or</b></li> <li><b>[2] Is identified with historic personages or is the site of an historic event in the Village, state or nation; or</b></li> <li><b>[3] Embodies the distinguishing characteristics of a type, period, style or method of architecture or engineering; or</b></li> <li><b>[4] Is the work of an important builder, designer, artist or architect whose work has significantly influenced an age; or</b></li> <li><b>[5] Because of its unique location or singular physical characteristics or landscape, represents an established and familiar visual or aesthetic feature of the neighborhood; or</b></li> <li><b>[6] Is significant for containing elements of design, details, materials or craftsmanship which represent a significant innovation; or</b></li> <li><b>[7] Has special historical significance to the Village of Sagaponack, Town of Southampton, County of Suffolk, State of New York, or the United States of America by reason of famous events or the antiquity or uniqueness of architectural construction or design.</b></li> </ul>

**Inventory of Selected Historic Structures Outside the National Register Historic District**

Sally Spanburgh – February 2017



Present View of Accessory Barn/Garage



View of home in 2000, Sagaponack National Register Nomination, Alison Cornish.



Village of Sagaponack

Inventory of Selected Historic Structures Outside the National Register Historic District

Sally Spanburgh – February 2017



Current Photo:

Property Name: Presbyterian Manse

Approximate Year Built: 1845

Property Street Address: 440 Town Line Road, Sagaponack, NY 11962

Suffolk County Tax Map Number: 908-7-2-24

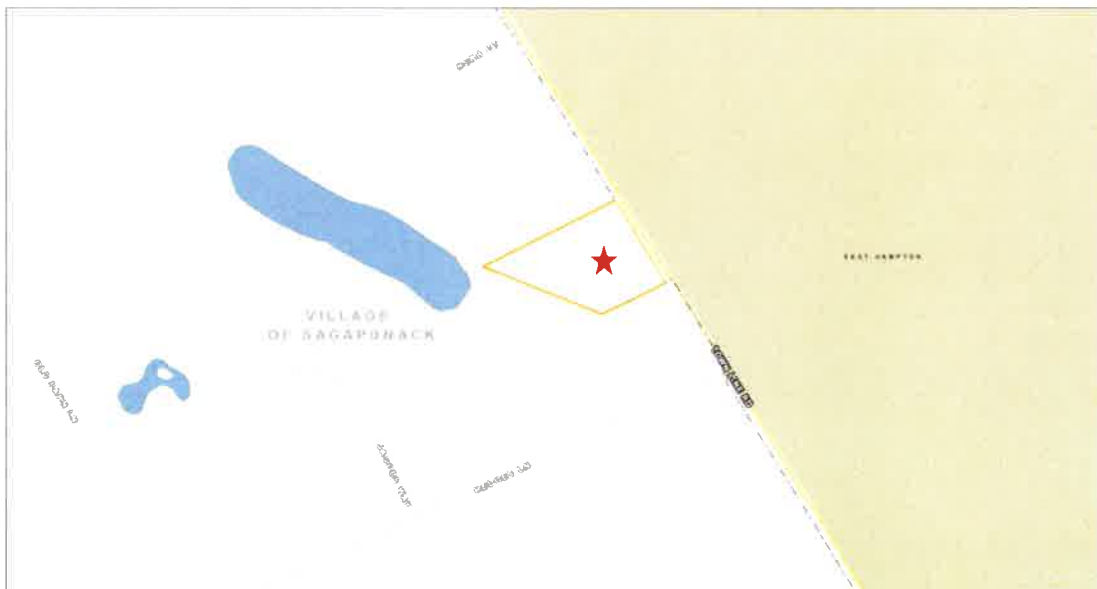

January 13 2017

Locator Map:



**Inventory of Selected Historic Structures Outside the National Register Historic District**

Sally Spanburgh – February 2017

Historical Summary: "The Magee house, as it is called today, was the Presbyterian Manse which was built after Rev. Cornelius Edgar arrived in 1845. The Rev. Arthur Newman, for forty-two years as Pastor, lived in the rambling white parsonage with its wide veranda, on Main Street just across from the church. Later it was moved to Hedges Lane on the north side and it remained there until a cold winter day in the 1980's, when the ground was frozen, it was once again moved to Townline (sic) Road."<sup>1</sup>

**Architectural Description:**

Contributing two-story tall, three bay wide home with front facing gable roof, kicked out eaves, and symmetrical cross gables. Sunburst pattern in woodwork at peaks of gable ends. Clad in painted clapboard siding and cedar shingle roofing. Double hung windows are symmetrically arranged. A one-story wrap-around porch has a hipped roof and Doric columns. The home has been renovated/updated. The windows are contemporary. The gable end windows do not appear original. The home's architectural character appears more closely aligned with a circa 1870 construction date. The home can be seen from the driveway opening.



Google Map Aerial View:

Existing, Related, Contributing Accessory Structures: No

**Historic Map References:**

1800: Not present.

1850: "Pres. Parsonage" on north side Main Street, Bridgehampton, across from church

1858: "Presb. Parsonage" on north side Main Street, Bridgehampton, across from church

1873: Present, un-named, on north side Main Street, Bridgehampton, across from church

1894: "Presb. Parsonage" on north side Main Street, Bridgehampton, across from church

1902: "Presb. Parsonage" on north side Main Street, Bridgehampton, across from church

1916: "Presby. Parsonage" on north side Main Street, Bridgehampton, across from church

<sup>11</sup> *Sagaponack Then and Now*, Carolyn Halsey and Barbara Albright, editors, 2006.

**Inventory of Selected Historic Structures Outside the National Register Historic District**

Sally Spanburgh – February 2017

## State/National Register Criteria:

The following criteria are used to evaluate properties for listing on the New York State and National Registers of Historic Places. (**Bolded** language is particularly relevant to the subject property.)

**The quality of significance in American history, architecture, archeology, engineering, and culture is present in districts, sites, buildings, structures, and objects that possess integrity of location, design, setting, materials, workmanship, feeling, and association, and:**

- a. that are associated with events that have made a significant contribution to the broad patterns of our history; or
- b. that are associated with the lives of persons significant in our past; or
- c. **that embody the distinctive characteristics of a type, period, or method of construction, or that represent the work of a master, or that possess high artistic values, or that represent a significant distinguishable entity whose components may lack individual distinction;** or
- d. that have yielded, or may be likely to yield, information important in prehistory or history.

## Village of Sagaponack Criteria: (Section 245-73 B (2) (d)):

(**Bolded** language is particularly relevant to the subject property.)

**[1] Possesses special character or historic or aesthetic interest or value as part of the cultural, political, economic or social history of the Village, region, state or nation; or**

[2] Is identified with historic personages or is the site of an historic event in the Village, state or nation; or

**[3] Embodies the distinguishing characteristics of a type, period, style or method of architecture or engineering; or**

[4] Is the work of an important builder, designer, artist or architect whose work has significantly influenced an age; or

[5] Because of its unique location or singular physical characteristics or landscape, represents an established and familiar visual or aesthetic feature of the neighborhood; or

[6] Is significant for containing elements of design, details, materials or craftsmanship which represent a significant innovation; or

**[7] Has special historical significance to the Village of Sagaponack, Town of Southampton, County of Suffolk, State of New York, or the United States of America by reason of famous events or the antiquity or uniqueness of architectural construction or design.**

13  
Village of Sagaponack  
**Inventory of Selected Historic Structures Outside the National Register Historic District**  
Sally Spanburgh – February 2017



Current Photo:

Property Name: Stephen (Jared) Hedges House	Approximate Year Built: 1730
Property Street Address: 602 Town Line Road, Sagaponack, NY 11962 (Previously: 542 Parsonage Lane, Sagaponack, NY 11962)	
Suffolk County Tax Map Number: 908-4-3-40	

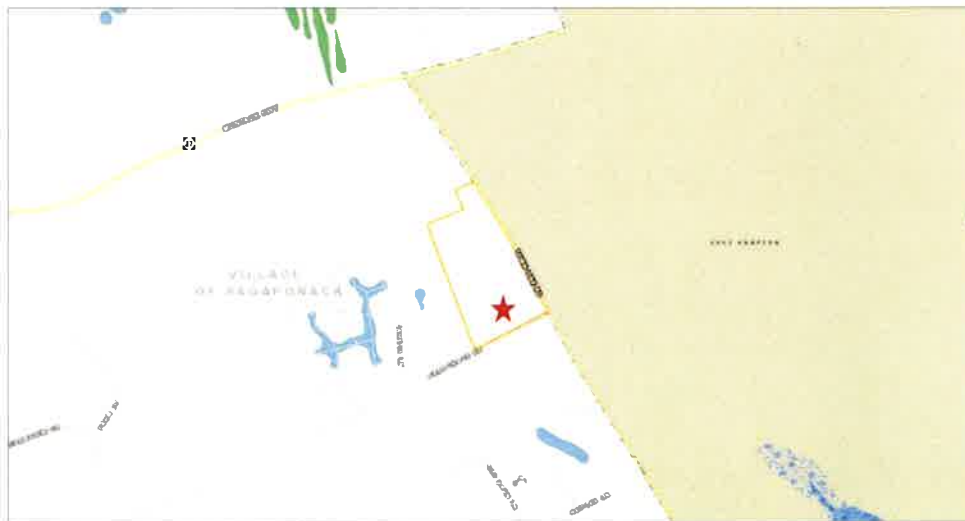

Locator Map:

## Inventory of Selected Historic Structures Outside the National Register Historic District

Sally Spanburgh – February 2017

Historical Summary: "Near the end of Parsonage Lane, Jared Hedges built his home in 1730. Bryan Hedges says that much of the original structure has been maintained. At one time when they were renovating, a beam with 1650 or 1652 written on it was found. When the chimney was redone a smoke house was discovered behind the chimney and it extended to the second floor. The entrance was from the attic which was behind the second floor. On the far north end of the farm was a barn where they were able to hide their cattle from the British during the Revolution."<sup>1</sup> Due to Jared Hedges' dates of birth and death (1770-1862) the house was likely inherited by Jared Hedges but built for an earlier Hedges ancestor. (Father: Stephen Hedges born 1747; Grandfather Daniel Hedges: 1702-1766.) Daniel Hedges served as a constable for the Town of Southampton in 1722; as a trustee in 1725, 1728 and 1730, 1737, 1747, 1750, 1758, 1753.<sup>2</sup> The Hedges family of Sagaponack descends from William Hedges (d.1674), the first of the family name in Southampton, listed as an inhabitant in 1644.

## Architectural Description:

Contributing south facing three bay wide, two story "half house" with saltbox form on stone foundation in original location. Large chimney and main entry set in eastern bay. Side facing gable roof. Four bay wide, one story wing to the east with chimney near eastern end; also with side-facing gable roof (easternmost bay may be a later addition). Two-story volume has a one-story rear ell set to the western side with gable roof. East wing has a shed roofed rear extension to the east side. House forms a U-shaped plan, potentially contributing to the formation of a courtyard at one time along with its several associated outbuildings. Home is clad in cedar shingle siding with corner boards and cedar shingle roofing; shingles on main volume have a larger exposure on the front than on other elevations. Chimneys are brick. Windows are double-hung with six-over-six or eight-over-eight divided light patterns, some of which have been updated with Victorian era double-hung units with two-over-two divisions. Eastern wing has 3-light transom windows. Main entry decorated with character defining surround. Property is openly visible to the public with Parsonage Lane frontage including picket fence.



Google Map Aerial View:

<sup>1</sup> *Sagaponack Then and Now*, 2006, Edited by Carolyn Halsey and Barbara Albright, pg. 46. *Sketches from Local History*, William D. Halsey, 1935, also states the home's construction date (for Stephen Hedges) as 1730.

<sup>2</sup> Town of Southampton, Book of Records, Vol. 3, pp. 51, 55, 57, 58, 63, 112, 147, 173, 244.



## Inventory of Selected Historic Structures Outside the National Register Historic District

Sally Spanburgh – February 2017

Existing, Related, Contributing Accessory Structures: Yes (Several contributing accessory sheds and barns, along with vernacular 1920 farmhouse on same property (see separate inventory form).)
<p>Historic Map References:</p> <p>1700 &amp; 1750: House associated with Stephen Hedges shown just west of subject structure.</p> <p>1800: "Jared Hedges"</p> <p>1850: "Chas. Hedges"</p> <p>1858: "J. Hedges" (Jared)</p> <p>1873: "C. O. Hedges" (Charles)</p> <p>1894: "C. O. Hedges" Est. (Charles)</p> <p>1902: "H. L. Hedges" (Hubert)</p> <p>1916: "H. L. Hedges" (Hubert)</p>
<p>State/National Register Criteria:</p> <p>The following criteria are used to evaluate properties for listing on the New York State and National Registers of Historic Places. (<b>Bolded</b> language is particularly relevant to the subject property.)</p> <p><b>The quality of significance in American history, architecture, archeology, engineering, and culture is present in districts, sites, buildings, structures, and objects that possess integrity of location, design, setting, materials, workmanship, feeling, and association, and:</b></p> <ol style="list-style-type: none"> <li>a. that are associated with events that have made a significant contribution to the broad patterns of our history; or</li> <li>b. that are associated with the lives of persons significant in our past; or</li> <li>c. <b>that embody the distinctive characteristics of a type, period, or method of construction, or that represent the work of a master, or that possess high artistic values, or that represent a significant distinguishable entity whose components may lack individual distinction; or</b></li> <li>d. <b>that have yielded, or may be likely to yield, information important in prehistory or history.</b></li> </ol>
<p>Village of Sagaponack Criteria: (Section 245-73 B (2) (d)):</p> <p>(<b>Bolded</b> language is particularly relevant to the subject property.)</p> <p><b>[1] Possesses special character or historic or aesthetic interest or value as part of the cultural, political, economic or social history of the Village, region, state or nation; or</b></p> <p>[2] Is identified with historic personages or is the site of an historic event in the Village, state or nation; or</p> <p><b>[3] Embodies the distinguishing characteristics of a type, period, style or method of architecture or engineering; or</b></p> <p>[4] Is the work of an important builder, designer, artist or architect whose work has significantly influenced an age; or</p> <p><b>[5] Because of its unique location or singular physical characteristics or landscape, represents an established and familiar visual or aesthetic feature of the neighborhood; or</b></p> <p>[6] Is significant for containing elements of design, details, materials or craftsmanship which represent a significant innovation; or</p> <p><b>[7] Has special historical significance to the Village of Sagaponack, Town of Southampton, County of Suffolk, State of New York, or the United States of America by reason of famous events or the antiquity or uniqueness of architectural construction or design.</b></p>

**Inventory of Selected Historic Structures Outside the National Register Historic District**

Sally Spanburgh – February 2017

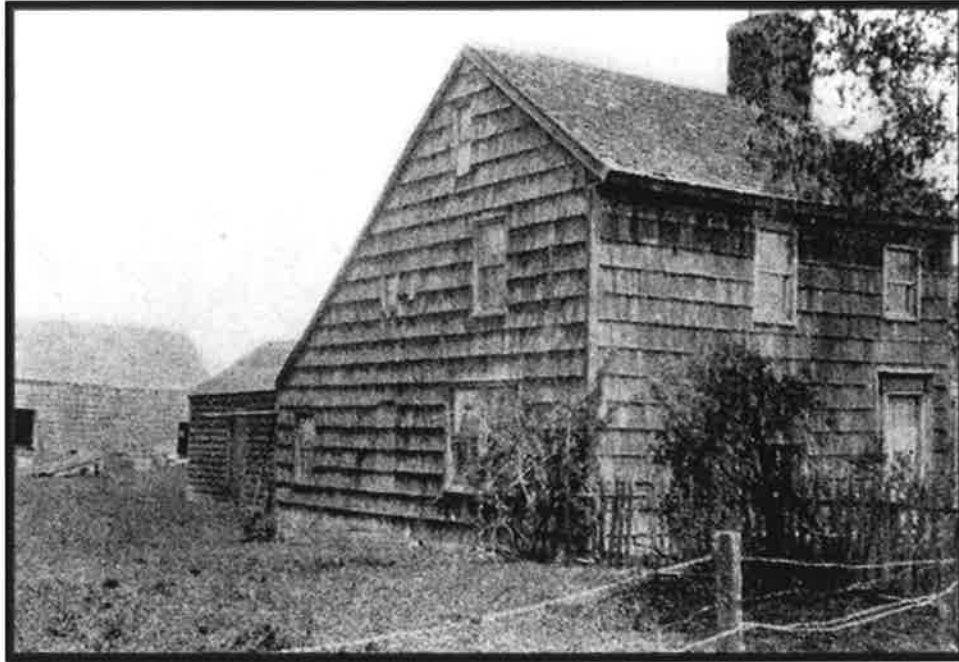

Vintage Imagery from Ancestry.com; also, *Sketches from Local History*, William Donaldson Halsey, 1935. Note number, size, and placement of windows.

14  
Village of Sagaponack  
**Inventory of Selected Historic Structures Outside the National Register Historic District**  
Sally Spanburgh – February 2017



Current Photo:

Property Name: Farmhouse	Approximate Year Built: 1906
Property Street Address: 602 Town Line Road, Sagaponack, NY 11962	
Suffolk County Tax Map Number: 908-4-3-40	



January 13, 2017

Locator Map:

## Inventory of Selected Historic Structures Outside the National Register Historic District

Sally Spanburgh – February 2017

## Historical Summary:

(See associated main house also at 602 town Line Road with separate inventory entry.) The subject home was likely originally built for Herbert L. Hedges to house farm laborers and later rented to those that also farmed associated Hedges family farmland.

Jared Hedges (1770-1862)

Charles Osborn Hedges (1823-1902); son of Jared Hedges

Herbert L. Hedges (1865-1947); son of Charles Osborn Hedges

## Architectural Description:

Contributing two story tall farmhouse in original location on concrete foundation. Three bays wide with full width one story front porch with hipped roof supported by turned posts. Brick chimney rises through center of roof. Front facing gable. Clad with cedar shingles with double hung windows symmetrically arranged. Property is openly visible to public from both Town Line Road and Parsonage Lane without tall hedges, landscaping or fencing blocking views.



Google Map Aerial View:

Existing, Related, Contributing Accessory Structures: Yes (Barns and Sheds)

## Historic Map References:

1858: Not present. Property owned by "J. Hedges" (Jared)

1873: Not present. Property owned by "C. O. Hedges" (Charles Osborn)

1894: Not present. Property owned by "C. O. Hedges Est." (Charles Osborn)

1902: Not present. Property owned by "H. L. Hedges" (Herbert)

1916: Not present. Property owned by "H. L. Hedges" (Herbert)

1930 Aerial: present

June 1938 Aerial: present

## State/National Register Criteria:

The following criteria are used to evaluate properties for listing on the New York State and National Registers of Historic Places. (**Bolded** language is particularly relevant to the subject property.)



## Inventory of Selected Historic Structures Outside the National Register Historic District

Sally Spanburgh – February 2017

The quality of significance in American history, architecture, archeology, engineering, and culture is present in districts, sites, buildings, structures, and objects that possess **integrity of location, design, setting, materials, workmanship, feeling, and association**, and:

- a. that are associated with events that have made a significant contribution to the broad patterns of our history; or
- b. that are associated with the lives of persons significant in our past; or
- c. **that embody the distinctive characteristics of a type, period, or method of construction**, or that represent the work of a master, or that possess high artistic values, or that represent a significant distinguishable entity whose components may lack individual distinction; or
- d. that have yielded, or may be likely to yield, information important in prehistory or history.

Village of Sagaponack Criteria: (Section 245-73 B (2) (d)):

(**Bolded** language is particularly relevant to the subject property.)

**[1] Possesses special character or historic or aesthetic interest or value as part of the cultural, political, economic or social history of the Village, region, state or nation; or**

[2] Is identified with historic personages or is the site of an historic event in the Village, state or nation; or

**[3] Embodies the distinguishing characteristics of a type, period, style or method of architecture or engineering; or**

[4] Is the work of an important builder, designer, artist or architect whose work has significantly influenced an age; or

[5] Because of its unique location or singular physical characteristics or landscape, represents an established and familiar visual or aesthetic feature of the neighborhood; or

[6] Is significant for containing elements of design, details, materials or craftsmanship which represent a significant innovation; or

**[7] Has special historical significance to the Village of Sagaponack, Town of Southampton, County of Suffolk, State of New York, or the United States of America by reason of famous events or the antiquity or uniqueness of architectural construction or design.**

now stationed at Bitter Plain, Montank.  
**H. L. Hedges** is carting gravel; it is  
 said preparatory to building a concrete  
 foundation for a new house.  
 N. L. Sanford, who has been suffering

*Sag Harbor Express, Nov. 30, 1905*

Village of Sagaponack

Inventory of Selected Historic Structures Outside the National Register Historic District

Sally Spanburgh – February 2017

**FORD**  
THE UNIVERSAL CAR

"Safety" —spell it the new way and it's "Ford." Certainty of operation—strength and lightness, made possible by Vanadium steel—simplicity of construction—these make the Ford the safest car in the world. A reason why every third car on the highway this year will be a Ford.

All Fords are Model T's—all alike except the bodies. The two passenger runabout costs \$700—the first passenger touring car \$850—the delivery car \$900—the town car \$900—f. o. b. Detroit, completely equipped. Get catalogue from Ford Motor Company, Michigan and Fourteenth Street—or direct from Detroit factory.

**Wm. H. & H. L. Hedges**  
DISTRIBUTING AGENTS  
Tel. J-R Bridgehampton WAINSCOTT, N. Y.

East Hampton Star, June 14, 1912

Vintage Newspaper Clippings:



Additional Current Views

15  
Village of Sagaponack  
**Inventory of Selected Historic Structures Outside the National Register Historic District**  
Sally Spanburgh – February 2017



Current Photo:

Property Name: Strong Farmhouse	Approximate Year Built: 1847
Property Street Address: 603 Town Line Road, Sagaponack, NY 11962	
Suffolk County Tax Map Number: 908-7-2-4	



Locator Map:

**Inventory of Selected Historic Structures Outside the National Register Historic District**

Sally Spanburgh – February 2017

Historical Summary: "On Townline (sic) Road on the southwest corner of Parsonage Lane is the Strong family farmhouse which was built in 1847 by James Strong, son of Talmage, who lived on the corner of Townline Road and Hedges Lane and it has been in the family ever since. The Strong farm at that time went from Parsonage Lane to Hedges Lane. The house had six fireplaces including one in the cellar that had a baking oven in it. It now has only two. The house was surrounded by pasture and had a turnstile at the front gate to keep the cows out. There is also a fertilizer house, potato house, chicken coop and milk house. A wheelwright shop was moved to the Bridgehampton Historical Society grounds in 1962. For many years potato farming was done on a large scale. Over time, the farm has become smaller. Today the main crop is pumpkins."<sup>1</sup>

James Rodgers Strong (1796-1866); Andrew Strong, (1829-abt.1912), son.

"The Strongs came from Taunton, England to New England in 1630, and Thomas Strong, fourth generation, settled in Wainscott shortly after 1700."<sup>2</sup>

**Architectural Description:**

Contributing Greek Revival style residence in its original location. Faces east toward the street. Two stories tall, three bays wide with side facing gable roof. Entry is offset in northern bay; chimney is offset in southern bay and rises through the roof ridge. A former rear one story ell has been removed along with most related accessory structures on the property (except a barn at 591 Parsonage Lane). Clad in cedar shingles with multi-light double hung windows symmetrically arranged. The home now functions as a guest house with a larger principal dwelling on the property. The home has been renovated; siding, roofing, doors, windows, and exterior moldings are contemporary.



2016 Google Map Aerial View:

Existing, Related, Contributing Accessory Structures: No (Strong Cottage survives at 591 Parsonage, an adjacent lot to the north, and a Strong barn survives at 581 Parsonage Lane, adjacent to the northwest.)

<sup>1</sup> *Sagaponack Then and Now*, Carolyn Halsey and Barbara Albright, editors, 2006.

<sup>2</sup> *East Hampton History Including Genealogies of Early Families*, Jeannette Edwards Rattray, 1953.



**Inventory of Selected Historic Structures Outside the National Register Historic District**

Sally Spanburgh – February 2017

<p>Historic Map References:          1750: Not present.          1800: Not present.          1850: "James Strong"          1858: "J. Strong" (James)          1873: "A. Strong" (Andrew)          1894: "A. Strong" (Andrew)          1902: "A. Strong" (Andrew)          1916: "Jas. Strong" (James S.)</p>
<p>State/National Register Criteria:          The following criteria are used to evaluate properties for listing on the New York State and National Registers of Historic Places. (<b>Bolded</b> language is particularly relevant to the subject property.)</p> <p><b>The quality of significance in American history, architecture, archeology, engineering, and culture is present in districts, sites, buildings, structures, and objects that possess integrity of location, design, setting, materials, workmanship, feeling, and association, and:</b></p> <ul style="list-style-type: none"> <li>a. that are associated with events that have made a significant contribution to the broad patterns of our history; or</li> <li>b. that are associated with the lives of persons significant in our past; or</li> <li>c. <b>that embody the distinctive characteristics of a type, period, or method of construction, or that represent the work of a master, or that possess high artistic values, or that represent a significant distinguishable entity whose components may lack individual distinction; or</b></li> <li>d. that have yielded, or may be likely to yield, information important in prehistory or history.</li> </ul>
<p>Village of Sagaponack Criteria: (Section 245-73 B (2) (d)):  <b>(Bolded language is particularly relevant to the subject property.)</b></p> <ul style="list-style-type: none"> <li><b>[1] Possesses special character or historic or aesthetic interest or value as part of the cultural, political, economic or social history of the Village, region, state or nation; or</b></li> <li>[2] Is identified with historic personages or is the site of an historic event in the Village, state or nation; or</li> <li><b>[3] Embodies the distinguishing characteristics of a type, period, style or method of architecture or engineering; or</b></li> <li>[4] Is the work of an important builder, designer, artist or architect whose work has significantly influenced an age; or</li> <li>[5] Because of its unique location or singular physical characteristics or landscape, represents an established and familiar visual or aesthetic feature of the neighborhood; or</li> <li>[6] Is significant for containing elements of design, details, materials or craftsmanship which represent a significant innovation; or</li> <li><b>[7] Has special historical significance to the Village of Sagaponack, Town of Southampton, County of Suffolk, State of New York, or the United States of America by reason of famous events or the antiquity or uniqueness of architectural construction or design.</b></li> </ul>

**Inventory of Selected Historic Structures Outside the National Register Historic District**

Sally Spanburgh – February 2017

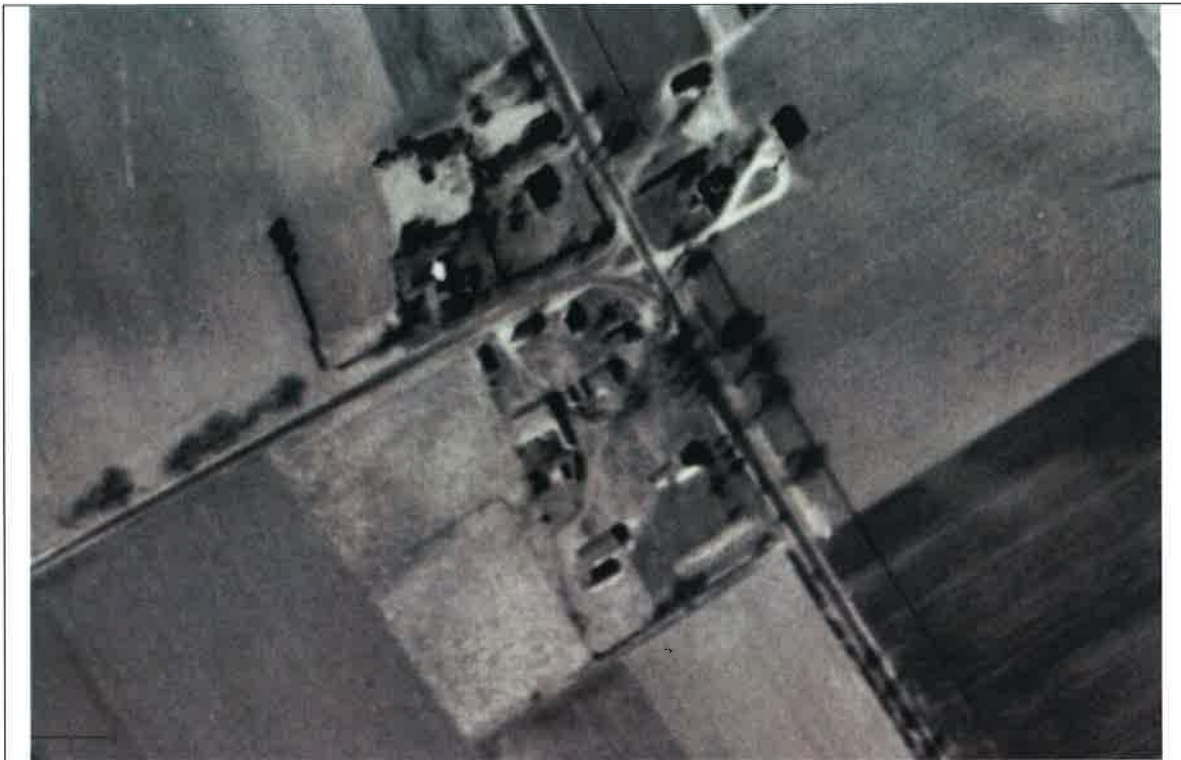

Above: 1962 Aerial Imagery; Below: 2001 Aerial Imagery (from Suffolk GIS)



**Inventory of Selected Historic Structures Outside the National Register Historic District**

Sally Spanburgh – February 2017



*View from Town Line Road in 2000, from Sagaponack National Register Nomination, Alison Cornish.*



*View from Parsonage Lane in 2000, from Sagaponack National Register Nomination, Alison Cornish*

16  
Village of Sagaponack  
**Inventory of Selected Historic Structures Outside the National Register Historic District**  
Sally Spanburgh – February 2017



Current Photo:

Property Name: Strong Cottage

Approximate Year Built: 1900

Property Street Address: 591 Parsonage Lane, Sagaponack, NY 11962

Suffolk County Tax Map Number: 908-7-2-3



Locator Map:



**Inventory of Selected Historic Structures Outside the National Register Historic District**

Sally Spanburgh – February 2017

Historical Summary: See related principal dwelling, Strong Farmhouse, at 603 Town Line Road.

"The Strongs came from Taunton, England to New England in 1630, and Thomas Strong, fourth generation, settled in Wainscott shortly after 1700."<sup>1</sup>

James Rodgers Strong (1796-1866)

Andrew Strong, (1829-abt.1912), son of James Rodgers Strong.

**Architectural Description:**

Contributing vernacular style agriculturally associated structure in its original location. Faces north toward the street. Two stories tall, one bay wide with front facing gable roof. Entry is offset in western bay. A one story full width extension with shed roof exists at the rear. Clad in cedar shingles on sides and rear and clapboard siding on the front façade. Original multi-light double hung windows symmetrically arranged throughout. The home now functions as a guest house with a contemporary principal home on the property. The subject structure likely originally functioned as farm labor housing, or a store, or both. The front clapboard siding does not appear to be original but the "dressing" of the front façade, along with the lack of a chimney, supports the possible use of the building as a store at one time. A view of the front façade is able to be seen from Parsonage Lane.



Google Map Aerial View:

Existing, Related, Contributing Accessory Structures: No (Associated Main House survives at 603 Town Line Road, on adjacent parcel to the south, and associated barn survives at 581 Parsonage Lane, adjacent to west.)

**Historic Map References:**

1858: Not present. Property owned by "J. Strong" (James R.)

1873: Not present. Property owned by "A. Strong" (Andrew)

1894: Not present. Property owned by "A. Strong"

1902: Present. Property owned by "A. Strong"

1916: Present. Property owned by "Jas. Strong" (James S.)

<sup>1</sup> *East Hampton History Including Genealogies of Early Families*, Jeannette Edwards Rattray, 1953.

**Inventory of Selected Historic Structures Outside the National Register Historic District**

Sally Spanburgh – February 2017

## State/National Register Criteria:

The following criteria are used to evaluate properties for listing on the New York State and National Registers of Historic Places. (**Bolded** language is particularly relevant to the subject property.)

**The quality of significance in American history, architecture, archeology, engineering, and culture is present in districts, sites, buildings, structures, and objects that possess integrity of location, design, setting, materials, workmanship, feeling, and association, and:**

- a. that are associated with events that have made a significant contribution to the broad patterns of our history; or
- b. that are associated with the lives of persons significant in our past; or
- c. **that embody the distinctive characteristics of a type, period, or method of construction, or that represent the work of a master, or that possess high artistic values, or that represent a significant distinguishable entity whose components may lack individual distinction; or**
- d. that have yielded, or may be likely to yield, information important in prehistory or history.

## Village of Sagaponack Criteria: (Section 245-73 B (2) (d)):

(**Bolded** language is particularly relevant to the subject property.)

**[1] Possesses special character or historic or aesthetic interest or value as part of the cultural, political, economic or social history of the Village, region, state or nation; or**

[2] Is identified with historic personages or is the site of an historic event in the Village, state or nation; or

**[3] Embodies the distinguishing characteristics of a type, period, style or method of architecture or engineering; or**

[4] Is the work of an important builder, designer, artist or architect whose work has significantly influenced an age; or

[5] Because of its unique location or singular physical characteristics or landscape, represents an established and familiar visual or aesthetic feature of the neighborhood; or

[6] Is significant for containing elements of design, details, materials or craftsmanship which represent a significant innovation; or

**[7] Has special historical significance to the Village of Sagaponack, Town of Southampton, County of Suffolk, State of New York, or the United States of America by reason of famous events or the antiquity or uniqueness of architectural construction or design.**